

PALACE

RESIDENCES DUBAI HILLS ESTATE

FLOOR PLANS - BUILDING 01 & TOWNHOUSES

EMAAR

PALACE

RESIDENCES DUBAI HILLS ESTATE

1 BEDROOM TYPE A.1

UNIT: G02

SUITE AREA:	676.51 SQ.FT	62.85 SQ.M
TERRACE AREA:	185.14 SQ.FT	17.2 SQ.M
TOTAL AREA:	861.65 SQ.FT	80.05 SQ.M

UNIT: G03

SUITE AREA:	679.96 SQ.FT	63.17 SQ.M
TERRACE AREA:	185.14 SQ.FT	17.2 SQ.M
TOTAL AREA:	865.1 SQ.FT	80.37 SQ.M



KEY SECTION

ROOF
21
20
19
18
17
16
15
14
13
12
11
10
09
08
07
06
05
04
03
02
01
PODIUM LEVEL
GROUND FLOOR
BASEMENT

KEY PLANS

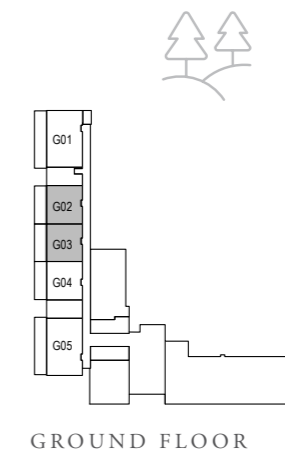

FLOOR PLAN 1. All dimensions are in imperial and metric, and measured from finish to finish excluding construction tolerances. . All materials, dimensions, and drawings are approximate only. 3. Information is subject to change without notice, at developer's absolute discretion. 4. Actual area may vary from the stated area. 5. Drawings not to scale. 6. All images used are for illustrative purposes only and do not represent the actual size, features, specifications, fittings, and furnishings. 7. The developer reserves the right to make revisions / alterations, at it's absolute discretion, without any liability whatsoever.

PALACE

RESIDENCES DUBAI HILLS ESTATE

1 BEDROOM TYPE A.2

UNIT: P02, 105, 205, 305, 405, 505, 605, 705, 805, 905,
1005, 1105, 1205, 1305, 1405, 1505

SUITE AREA:	680.71 SQ.FT	63.24 SQ.M
BALCONY AREA:	70.93 SQ.FT	6.59 SQ.M
TOTAL AREA:	751.64 SQ.FT	69.83 SQ.M

UNIT: 1601, 1701, 1801, 1901, 2001, 2101

SUITE AREA:	678.88 SQ.FT	63.07 SQ.M
BALCONY AREA:	70.93 SQ.FT	6.59 SQ.M
TOTAL AREA:	749.81 SQ.FT	69.66 SQ.M



KEY SECTION

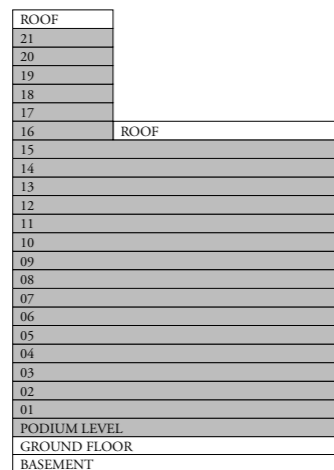

KEY PLANS

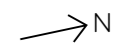

FLOOR PLAN 1. All dimensions are in imperial and metric, and measured from finish to finish excluding construction tolerances. 2. All materials, dimensions, and drawings are approximate only. 3. Information is subject to change without notice, at developer's absolute discretion. 4. Actual area may vary from the stated area. 5. Drawings not to scale. 6. All images used are for illustrative purposes only and do not represent the actual size, features, specifications, fittings, and furnishings. 7. The developer reserves the right to make revisions / alterations, at its absolute discretion, without any liability whatsoever.

PALACE

RESIDENCES DUBAI HILLS ESTATE

1 BEDROOM TYPE A.2

UNIT: P03, 106

SUITE AREA:	676.19 SQ.FT	62.82 SQ.M
BALCONY AREA:	70.93 SQ.FT	6.59 SQ.M
TOTAL AREA:	747.12 SQ.FT	69.41 SQ.M

UNIT: 206, 306, 406, 506, 606, 706, 806, 906, 1006, 1106, 1206, 1306, 1406, 1506

SUITE AREA:	676.19 SQ.FT	62.82 SQ.M
BALCONY AREA:	71.04 SQ.FT	6.60 SQ.M
TOTAL AREA:	747.23 SQ.FT	69.42 SQ.M



KEY SECTION

ROOF
21
20
19
18
17
16
15
14
13
12
11
10
09
08
07
06
05
04
03
02
01
PODIUM LEVEL
GROUND FLOOR
BASEMENT

KEY PLANS

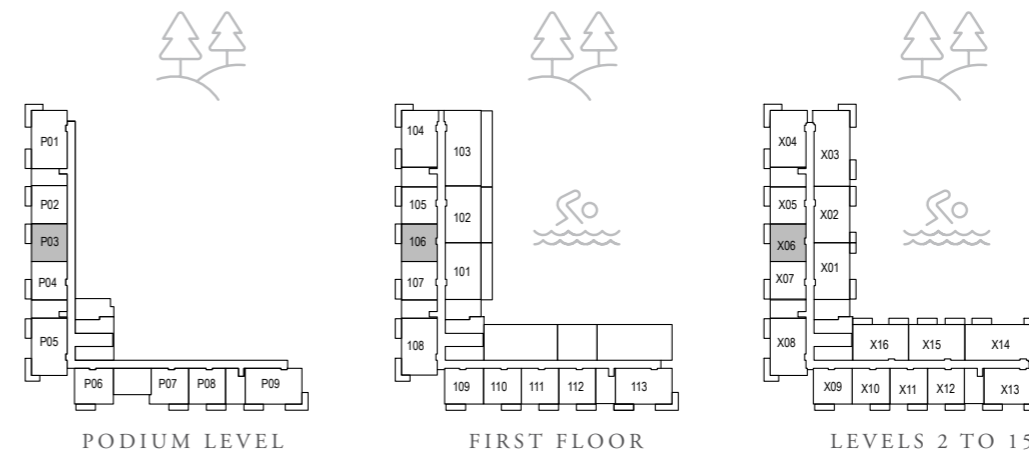

FLOOR PLAN 1. All dimensions are in imperial and metric, and measured from finish to finish excluding construction tolerances. 2. All materials, dimensions, and drawings are approximate only. 3. Information is subject to change without notice, at developer's absolute discretion. 4. Actual area may vary from the stated area. 5. Drawings not to scale. 6. All images used are for illustrative purposes only and do not represent the actual size, features, specifications, fittings, and furnishings. 7. The developer reserves the right to make revisions / alterations, at its absolute discretion, without any liability whatsoever.

PALACE

RESIDENCES DUBAI HILLS ESTATE

1 BEDROOM TYPE A.2

UNIT: P06, 109

SUITE AREA:	682.65 SQ.FT	63.42 SQ.M
BALCONY AREA:	70.93 SQ.FT	6.59 SQ.M
TOTAL AREA:	753.58 SQ.FT	70.01 SQ.M

UNIT: 209, 309, 409, 509, 609, 709, 809, 909, 1009, 1109,
1209, 1309, 1409, 1509

SUITE AREA:	686.85 SQ.FT	63.81 SQ.M
BALCONY AREA:	70.93 SQ.FT	6.59 SQ.M
TOTAL AREA:	757.78 SQ.FT	70.40 SQ.M



KEY SECTION

ROOF
21
20
19
18
17
16
15
14
13
12
11
10
09
08
07
06
05
04
03
02
01
PODIUM LEVEL
GROUND FLOOR
BASEMENT

KEY PLANS



FLOOR PLAN 1. All dimensions are in imperial and metric, and measured from finish to finish excluding construction tolerances. 2. All materials, dimensions, and drawings are approximate only. 3. Information is subject to change without notice, at developer's absolute discretion. 4. Actual area may vary from the stated area. 5. Drawings not to scale. 6. All images used are for illustrative purposes only and do not represent the actual size, features, specifications, fittings, and furnishings. 7. The developer reserves the right to make revisions / alterations, at its absolute discretion, without any liability whatsoever.

PALACE

RESIDENCES DUBAI HILLS ESTATE

1 BEDROOM TYPE A.4

UNIT: G04

SUITE AREA:	679.31 SQ.FT	63.11 SQ.M
TERRACE AREA:	186.54 SQ.FT	17.33 SQ.M
TOTAL AREA:	865.85 SQ.FT	80.44 SQ.M



KEY SECTION

ROOF
21
20
19
18
17
16
15
14
13
12
11
10
09
08
07
06
05
04
03
02
01
PODIUM LEVEL
GROUND FLOOR
BASEMENT

KEY PLANS

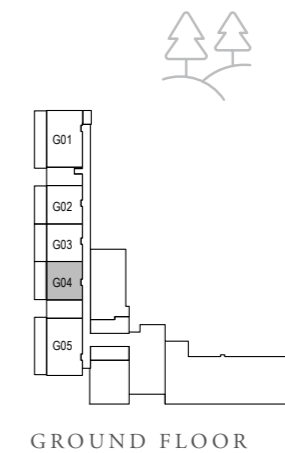

FLOOR PLAN 1. All dimensions are in imperial and metric, and measured from finish to finish excluding construction tolerances. . All materials, dimensions, and drawings are approximate only. 3. Information is subject to change without notice, at developer's absolute discretion. 4. Actual area may vary from the stated area. 5. Drawings not to scale. 6. All images used are for illustrative purposes only and do not represent the actual size, features, specifications, fittings, and furnishings. 7. The developer reserves the right to make revisions / alterations, at it's absolute discretion, without any liability whatsoever.

PALACE

RESIDENCES DUBAI HILLS ESTATE

1 BEDROOM TYPE A.5

UNIT: P04, 107

SUITE AREA:	679.31 SQ.FT	63.11 SQ.M
BALCONY AREA:	72.23 SQ.FT	6.71 SQ.M
TOTAL AREA:	751.54 SQ.FT	69.82 SQ.M

UNIT: 207, 307, 407, 507, 607, 707, 807, 907, 1007, 1107,
1207, 1307, 1407, 1507

SUITE AREA:	679.85 SQ.FT	63.16 SQ.M
BALCONY AREA:	71.80 SQ.FT	6.67 SQ.M
TOTAL AREA:	751.64 SQ.FT	69.83 SQ.M



KEY SECTION

ROOF
21
20
19
18
17
16
15
14
13
12
11
10
09
08
07
06
05
04
03
02
01
PODIUM LEVEL
GROUND FLOOR
BASEMENT

KEY PLANS

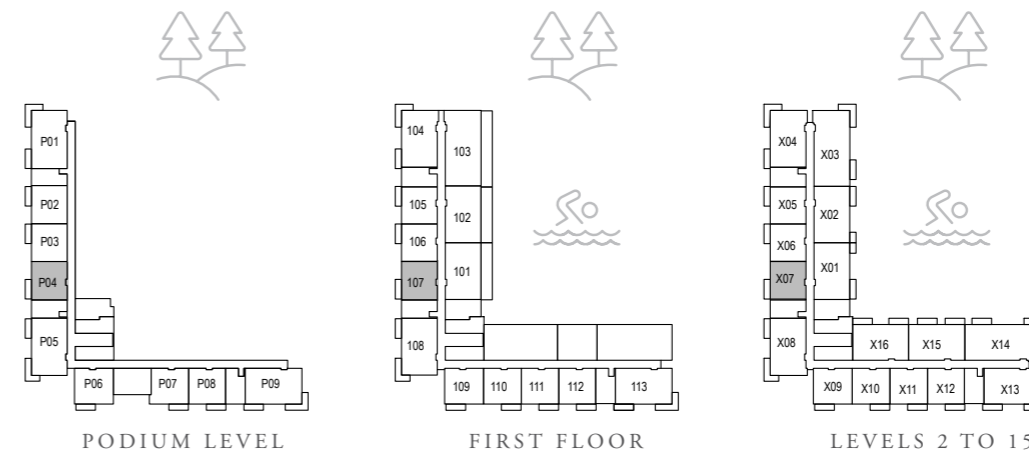

FLOOR PLAN 1. All dimensions are in imperial and metric, and measured from finish to finish excluding construction tolerances. 2. All materials, dimensions, and drawings are approximate only. 3. Information is subject to change without notice, at developer's absolute discretion. 4. Actual area may vary from the stated area. 5. Drawings not to scale. 6. All images used are for illustrative purposes only and do not represent the actual size, features, specifications, fittings, and furnishings. 7. The developer reserves the right to make revisions / alterations, at its absolute discretion, without any liability whatsoever.

PALACE

RESIDENCES DUBAI HILLS ESTATE

1 BEDROOM TYPE A.5

UNIT: P07, 111

SUITE AREA:	676.19 SQ.FT	62.82 SQ.M
BALCONY AREA:	70.93 SQ.FT	6.59 SQ.M
TOTAL AREA:	747.12 SQ.FT	69.41 SQ.M

UNIT: 110

SUITE AREA:	680.28 SQ.FT	63.20 SQ.M
BALCONY AREA:	70.93 SQ.FT	6.59 SQ.M
TOTAL AREA:	751.21 SQ.FT	69.79 SQ.M



KEY SECTION

ROOF
21
20
19
18
17
16
15
14
13
12
11
10
09
08
07
06
05
04
03
02
01
PODIUM LEVEL
GROUND FLOOR
BASEMENT

KEY PLANS

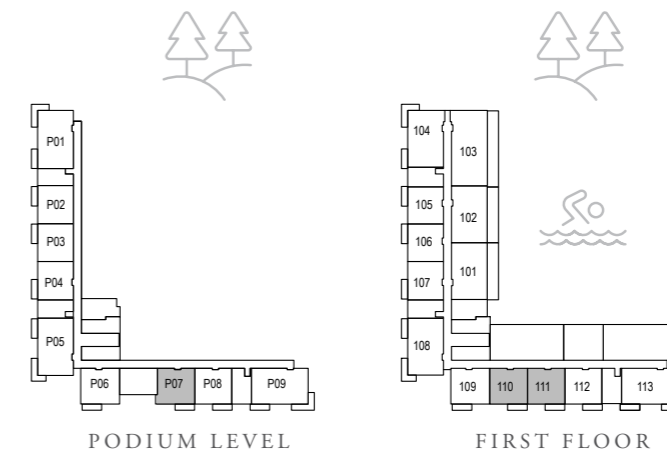

FLOOR PLAN 1. All dimensions are in imperial and metric, and measured from finish to finish excluding construction tolerances. 2. All materials, dimensions, and drawings are approximate only. 3. Information is subject to change without notice, at developer's absolute discretion. 4. Actual area may vary from the stated area. 5. Drawings not to scale. 6. All images used are for illustrative purposes only and do not represent the actual size, features, specifications, fittings, and furnishings. 7. The developer reserves the right to make revisions / alterations, at its absolute discretion, without any liability whatsoever.

PALACE

RESIDENCES DUBAI HILLS ESTATE

1 BEDROOM TYPE A.5

UNIT: P08, 112, 211, 311, 411, 511, 611, 711, 811, 911,
1011, 1111, 1211, 1311, 1411, 1511

SUITE AREA:	676.51 SQ.FT	62.85 SQ.M
BALCONY AREA:	70.93 SQ.FT	6.59 SQ.M
TOTAL AREA:	747.45 SQ.FT	69.44 SQ.M

UNIT: 212, 312, 412, 512, 612, 712, 812, 912, 1012, 1112,
1212, 1312, 1412, 1512

SUITE AREA:	680.17 SQ.FT	63.19 SQ.M
BALCONY AREA:	70.93 SQ.FT	6.59 SQ.M
TOTAL AREA:	751.11 SQ.FT	69.78 SQ.M



KEY SECTION

ROOF
21
20
19
18
17
16
15
14
13
12
11
10
09
08
07
06
05
04
03
02
01
PODIUM LEVEL
GROUND FLOOR
BASEMENT

KEY PLANS

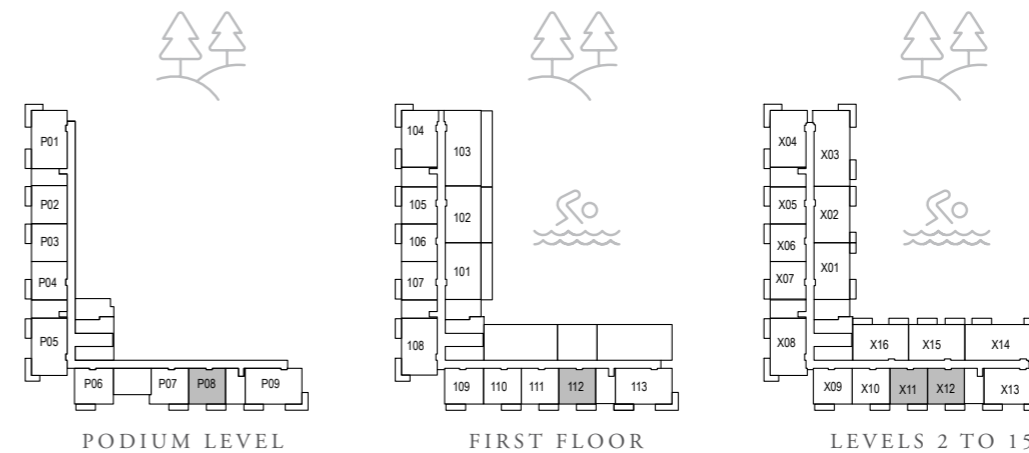

FLOOR PLAN 1. All dimensions are in imperial and metric, and measured from finish to finish excluding construction tolerances. 2. All materials, dimensions, and drawings are approximate only. 3. Information is subject to change without notice, at developer's absolute discretion. 4. Actual area may vary from the stated area. 5. Drawings not to scale. 6. All images used are for illustrative purposes only and do not represent the actual size, features, specifications, fittings, and furnishings. 7. The developer reserves the right to make revisions / alterations, at its absolute discretion, without any liability whatsoever.

PALACE

RESIDENCES DUBAI HILLS ESTATE

1 BEDROOM TYPE A.5

UNIT: 210, 310, 410, 510, 610, 710, 810, 910, 1010, 1110,
1210, 1310, 1410, 1510

SUITE AREA:	672.42 SQ.FT	62.47 SQ.M
BALCONY AREA:	70.93 SQ.FT	6.59 SQ.M
TOTAL AREA:	743.36 SQ.FT	69.06 SQ.M



KEY SECTION

ROOF
21
20
19
18
17
16
15
14
13
12
11
10
09
08
07
06
05
04
03
02
01
PODIUM LEVEL
GROUND FLOOR
BASEMENT

KEY PLANS

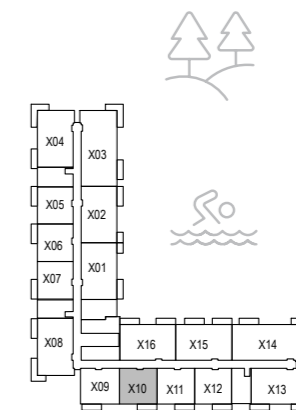

LEVELS 2 TO 15

FLOOR PLAN 1. All dimensions are in imperial and metric, and measured from finish to finish excluding construction tolerances. 2. All materials, dimensions, and drawings are approximate only. 3. Information is subject to change without notice, at developer's absolute discretion. 4. Actual area may vary from the stated area. 5. Drawings not to scale. 6. All images used are for illustrative purposes only and do not represent the actual size, features, specifications, fittings, and furnishings. 7. The developer reserves the right to make revisions / alterations, at its absolute discretion, without any liability whatsoever.

PALACE

RESIDENCES DUBAI HILLS ESTATE

2 BEDROOM TYPE A.1

UNIT: G01

SUITE AREA:	1033.23 SQ.FT	95.99 SQ.M
TERRACE AREA:	275.99 SQ.FT	25.64 SQ.M
TOTAL AREA:	1309.21 SQ.FT	121.63 SQ.M



KEY SECTION

ROOF
21
20
19
18
17
16
15
14
13
12
11
10
09
08
07
06
05
04
03
02
01
PODIUM LEVEL
GROUND FLOOR
BASEMENT

KEY PLANS

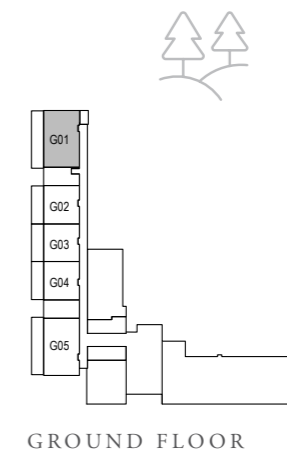

FLOOR PLAN 1. All dimensions are in imperial and metric, and measured from finish to finish excluding construction tolerances. . All materials, dimensions, and drawings are approximate only. 3. Information is subject to change without notice, at developer's absolute discretion. 4. Actual area may vary from the stated area. 5. Drawings not to scale. 6. All images used are for illustrative purposes only and do not represent the actual size, features, specifications, fittings, and furnishings. 7. The developer reserves the right to make revisions / alterations, at it's absolute discretion, without any liability whatsoever.

PALACE

RESIDENCES DUBAI HILLS ESTATE

2 BEDROOM TYPE A.2

UNIT: P01

SUITE AREA:	1034.63 SQ.FT	96.12 SQ.M
BALCONY AREA:	184.28 SQ.FT	17.12 SQ.M
TOTAL AREA:	1218.91 SQ.FT	113.24 SQ.M

UNIT: 104

SUITE AREA:	1034.73 SQ.FT	96.13 SQ.M
BALCONY AREA:	184.17 SQ.FT	17.11 SQ.M
TOTAL AREA:	1218.91 SQ.FT	113.24 SQ.M



KEY SECTION

ROOF
21
20
19
18
17
16
15
14
13
12
11
10
09
08
07
06
05
04
03
02
01
PODIUM LEVEL
GROUND FLOOR
BASEMENT

KEY PLANS

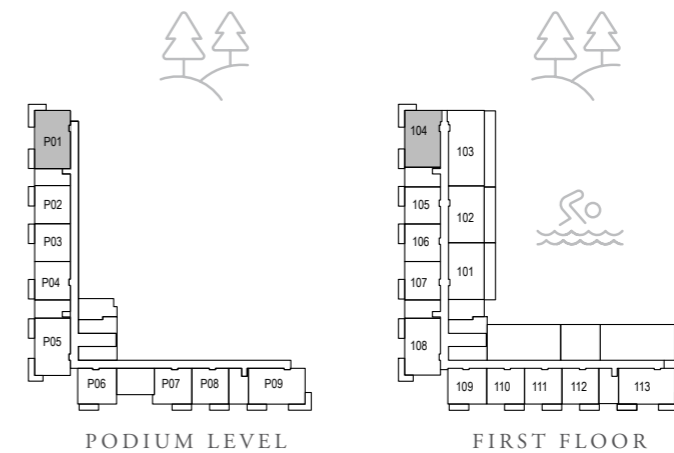

FLOOR PLAN 1. All dimensions are in imperial and metric, and measured from finish to finish excluding construction tolerances. 2. All materials, dimensions, and drawings are approximate only. 3. Information is subject to change without notice, at developer's absolute discretion. 4. Actual area may vary from the stated area. 5. Drawings not to scale. 6. All images used are for illustrative purposes only and do not represent the actual size, features, specifications, fittings, and furnishings. 7. The developer reserves the right to make revisions / alterations, at its absolute discretion, without any liability whatsoever.

PALACE

RESIDENCES DUBAI HILLS ESTATE

2 BEDROOM TYPE A.2

UNIT: 204, 304, 404, 504, 604, 704, 804, 904, 1004, 1104,
1204, 1304, 1404, 1504, 1604, 1704, 1804, 1904, 2004,
2104

SUITE AREA:	1035.70 SQ.FT	96.22 SQ.M
BALCONY AREA:	183.85 SQ.FT	17.08 SQ.M
TOTAL AREA:	1219.55 SQ.FT	113.30 SQ.M



KEY SECTION

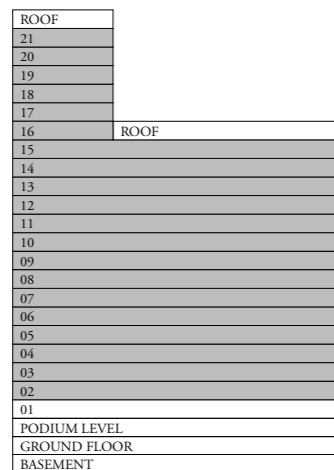

KEY PLANS

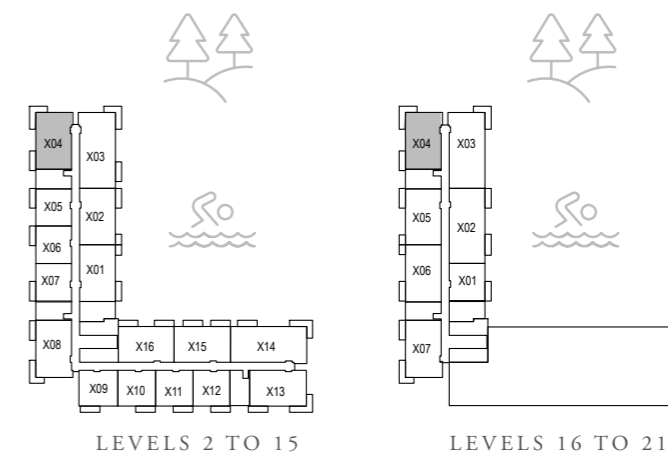

FLOOR PLAN 1. All dimensions are in imperial and metric, and measured from finish to finish excluding construction tolerances. 2. All materials, dimensions, and drawings are approximate only. 3. Information is subject to change without notice, at developer's absolute discretion. 4. Actual area may vary from the stated area. 5. Drawings not to scale. 6. All images used are for illustrative purposes only and do not represent the actual size, features, specifications, fittings, and furnishings. 7. The developer reserves the right to make revisions / alterations, at its absolute discretion, without any liability whatsoever.

PALACE

RESIDENCES DUBAI HILLS ESTATE

2 BEDROOM TYPE A.4

UNIT: P09

SUITE AREA:	1035.81 SQ.FT	96.23 SQ.M
BALCONY AREA:	183.96 SQ.FT	17.09 SQ.M
TOTAL AREA:	1219.77 SQ.FT	113.32 SQ.M

UNIT: 113

SUITE AREA:	1034.41 SQ.FT	96.10 SQ.M
BALCONY AREA:	183.85 SQ.FT	17.08 SQ.M
TOTAL AREA:	1218.26 SQ.FT	113.18 SQ.M



KEY SECTION

ROOF
21
20
19
18
17
16
15
14
13
12
11
10
09
08
07
06
05
04
03
02
01
PODIUM LEVEL
GROUND FLOOR
BASEMENT

KEY PLANS

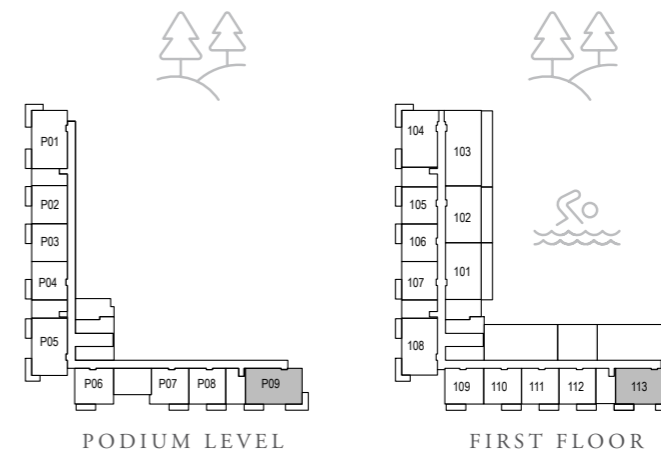

FLOOR PLAN 1. All dimensions are in imperial and metric, and measured from finish to finish excluding construction tolerances. 2. All materials, dimensions, and drawings are approximate only. 3. Information is subject to change without notice, at developer's absolute discretion. 4. Actual area may vary from the stated area. 5. Drawings not to scale. 6. All images used are for illustrative purposes only and do not represent the actual size, features, specifications, fittings, and furnishings. 7. The developer reserves the right to make revisions / alterations, at its absolute discretion, without any liability whatsoever.

PALACE

RESIDENCES DUBAI HILLS ESTATE

2 BEDROOM TYPE A.4

UNIT: 213, 313, 413, 513, 613, 713, 813, 913, 1013, 1113,
1213, 1313, 1413, 1513

SUITE AREA:	1035.38 SQ.FT	96.19 SQ.M
BALCONY AREA:	183.85 SQ.FT	17.08 SQ.M
TOTAL AREA:	1219.23 SQ.FT	113.27 SQ.M



KEY SECTION

ROOF
21
20
19
18
17
16
15
14
13
12
11
10
09
08
07
06
05
04
03
02
01
PODIUM LEVEL
GROUND FLOOR
BASEMENT

KEY PLANS

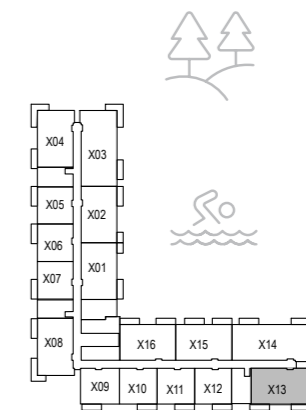

LEVELS 2 TO 15

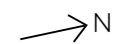

FLOOR PLAN 1. All dimensions are in imperial and metric, and measured from finish to finish excluding construction tolerances. 2. All materials, dimensions, and drawings are approximate only. 3. Information is subject to change without notice, at developer's absolute discretion. 4. Actual area may vary from the stated area. 5. Drawings not to scale. 6. All images used are for illustrative purposes only and do not represent the actual size, features, specifications, fittings, and furnishings. 7. The developer reserves the right to make revisions / alterations, at its absolute discretion, without any liability whatsoever.

PALACE

RESIDENCES DUBAI HILLS ESTATE

2 BEDROOM TYPE B.1

UNIT: G05

SUITE AREA:	1030.43 SQ.FT	95.73 SQ.M
TERRACE AREA:	277.06 SQ.FT	25.74 SQ.M
TOTAL AREA:	1307.49 SQ.FT	121.47 SQ.M



KEY SECTION

ROOF
21
20
19
18
17
16
15
14
13
12
11
10
09
08
07
06
05
04
03
02
01
PODIUM LEVEL
GROUND FLOOR
BASEMENT

KEY PLANS

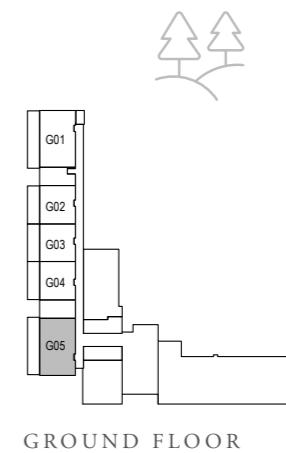

FLOOR PLAN 1. All dimensions are in imperial and metric, and measured from finish to finish excluding construction tolerances. . All materials, dimensions, and drawings are approximate only. 3. Information is subject to change without notice, at developer's absolute discretion. 4. Actual area may vary from the stated area. 5. Drawings not to scale. 6. All images used are for illustrative purposes only and do not represent the actual size, features, specifications, fittings, and furnishings. 7. The developer reserves the right to make revisions / alterations, at it's absolute discretion, without any liability whatsoever.

PALACE

RESIDENCES DUBAI HILLS ESTATE

2 BEDROOM TYPE B.2

UNIT: P05

SUITE AREA:	1031.83 SQ.FT	95.86 SQ.M
BALCONY AREA:	174.16 SQ.FT	16.18 SQ.M
TOTAL AREA:	1205.99 SQ.FT	112.04 SQ.M

UNIT: 108

SUITE AREA:	1031.94 SQ.FT	95.87 SQ.M
BALCONY AREA:	174.16 SQ.FT	16.18 SQ.M
TOTAL AREA:	1206.10 SQ.FT	112.05 SQ.M



KEY SECTION

ROOF
21
20
19
18
17
16
15
14
13
12
11
10
09
08
07
06
05
04
03
02
01
PODIUM LEVEL
GROUND FLOOR
BASEMENT

KEY PLANS

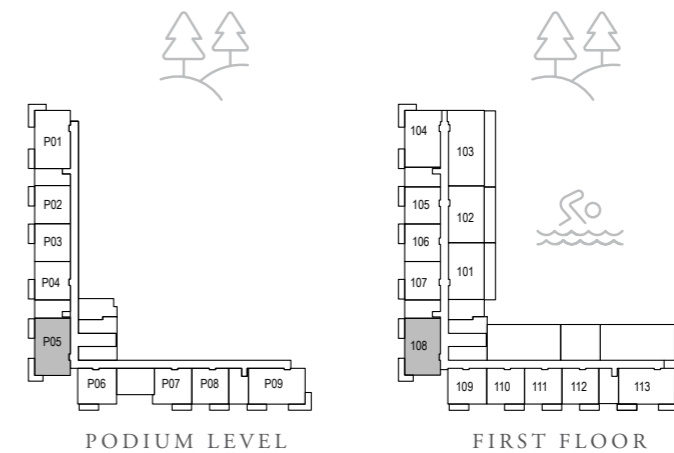

FLOOR PLAN 1. All dimensions are in imperial and metric, and measured from finish to finish excluding construction tolerances. 2. All materials, dimensions, and drawings are approximate only. 3. Information is subject to change without notice, at developer's absolute discretion. 4. Actual area may vary from the stated area. 5. Drawings not to scale. 6. All images used are for illustrative purposes only and do not represent the actual size, features, specifications, fittings, and furnishings. 7. The developer reserves the right to make revisions / alterations, at its absolute discretion, without any liability whatsoever.

PALACE

RESIDENCES DUBAI HILLS ESTATE

2 BEDROOM TYPE B.2

UNIT: 208, 308, 408, 508, 608, 708, 808, 908, 1008, 1108,
1208, 1308, 1408, 1508

SUITE AREA:	1033.23 SQ.FT	95.99 SQ.M
BALCONY AREA:	173.84 SQ.FT	16.15 SQ.M
TOTAL AREA:	1207.06 SQ.FT	112.14 SQ.M



KEY SECTION

ROOF
21
20
19
18
17
16
15
14
13
12
11
10
09
08
07
06
05
04
03
02
01
PODIUM LEVEL
GROUND FLOOR
BASEMENT

KEY PLANS

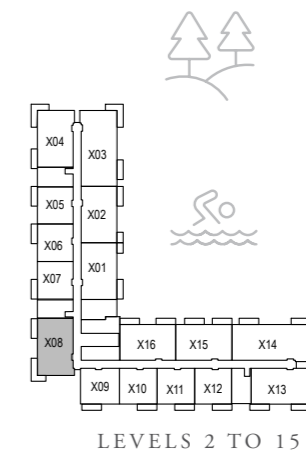

FLOOR PLAN 1. All dimensions are in imperial and metric, and measured from finish to finish excluding construction tolerances. 2. All materials, dimensions, and drawings are approximate only. 3. Information is subject to change without notice, at developer's absolute discretion. 4. Actual area may vary from the stated area. 5. Drawings not to scale. 6. All images used are for illustrative purposes only and do not represent the actual size, features, specifications, fittings, and furnishings. 7. The developer reserves the right to make revisions / alterations, at its absolute discretion, without any liability whatsoever.

PALACE

RESIDENCES DUBAI HILLS ESTATE

2 BEDROOM TYPE B.2

UNIT: 1607

SUITE AREA:	1036.78 SQ.FT	96.32 SQ.M
BALCONY AREA:	172.22 SQ.FT	16.00 SQ.M
TOTAL AREA:	1209.00 SQ.FT	112.32 SQ.M

UNIT: 1707, 1807, 1907, 2007, 2107

SUITE AREA:	1035.7 SQ.FT	96.22 SQ.M
BALCONY AREA:	172.33 SQ.FT	16.01 SQ.M
TOTAL AREA:	1208.03 SQ.FT	112.23 SQ.M



KEY SECTION

ROOF
21
20
19
18
17
16
15
14
13
12
11
10
09
08
07
06
05
04
03
02
01
PODIUM LEVEL
GROUND FLOOR
BASEMENT

KEY PLANS

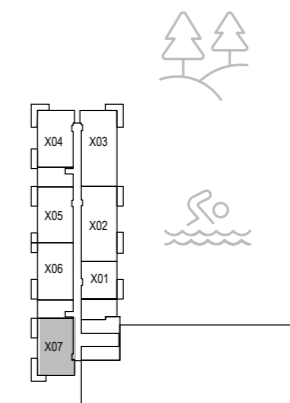

LEVELS 16 TO 21

FLOOR PLAN 1. All dimensions are in imperial and metric, and measured from finish to finish excluding construction tolerances. 2. All materials, dimensions, and drawings are approximate only. 3. Information is subject to change without notice, at developer's absolute discretion. 4. Actual area may vary from the stated area. 5. Drawings not to scale. 6. All images used are for illustrative purposes only and do not represent the actual size, features, specifications, fittings, and furnishings. 7. The developer reserves the right to make revisions / alterations, at its absolute discretion, without any liability whatsoever.

PALACE

RESIDENCES DUBAI HILLS ESTATE

2 BEDROOM TYPE C.1

UNIT: 102

SUITE AREA:	1011.92 SQ.FT	94.01 SQ.M
TERRACE AREA:	352.63 SQ.FT	32.76 SQ.M
TOTAL AREA:	1364.54 SQ.FT	126.77 SQ.M



KEY SECTION

ROOF
21
20
19
18
17
16
15
14
13
12
11
10
09
08
07
06
05
04
03
02
01
PODIUM LEVEL
GROUND FLOOR
BASEMENT

KEY PLANS

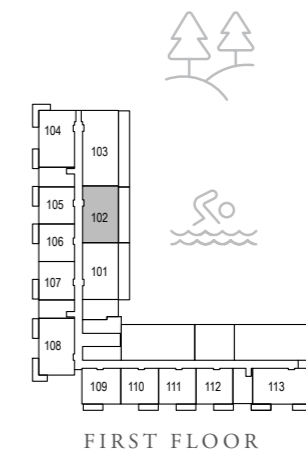

FLOOR PLAN 1. All dimensions are in imperial and metric, and measured from finish to finish excluding construction tolerances. 2. All materials, dimensions, and drawings are approximate only. 3. Information is subject to change without notice, at developer's absolute discretion. 4. Actual area may vary from the stated area. 5. Drawings not to scale. 6. All images used are for illustrative purposes only and do not represent the actual size, features, specifications, fittings, and furnishings. 7. The developer reserves the right to make revisions / alterations, at its absolute discretion, without any liability whatsoever.

PALACE

RESIDENCES DUBAI HILLS ESTATE

2 BEDROOM TYPE C.2

UNIT: 202, 302, 402, 502, 602, 702, 802, 902, 1002, 1102,
1202, 1302, 1402, 1502

SUITE AREA:	1009.65 SQ.FT	93.8 SQ.M
BALCONY AREA:	109.04 SQ.FT	10.13 SQ.M
TOTAL AREA:	1118.69 SQ.FT	103.93 SQ.M



KEY SECTION

ROOF
21
20
19
18
17
16
15
14
13
12
11
10
09
08
07
06
05
04
03
02
01
PODIUM LEVEL
GROUND FLOOR
BASEMENT

KEY PLANS

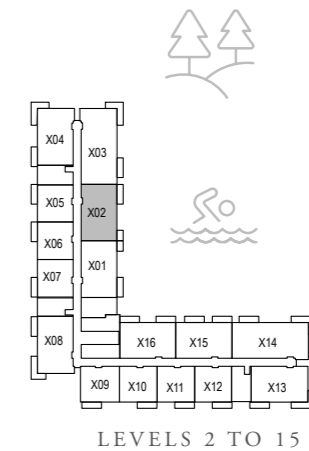

FLOOR PLAN 1. All dimensions are in imperial and metric, and measured from finish to finish excluding construction tolerances. 2. All materials, dimensions, and drawings are approximate only. 3. Information is subject to change without notice, at developer's absolute discretion. 4. Actual area may vary from the stated area. 5. Drawings not to scale. 6. All images used are for illustrative purposes only and do not represent the actual size, features, specifications, fittings, and furnishings. 7. The developer reserves the right to make revisions / alterations, at its absolute discretion, without any liability whatsoever.

PALACE

RESIDENCES DUBAI HILLS ESTATE

2 BEDROOM TYPE C.3

UNIT: 101

SUITE AREA:	1005.67 SQ.FT	93.43 SQ.M
TERRACE AREA:	354.03 SQ.FT	32.89 SQ.M
TOTAL AREA:	1359.7 SQ.FT	126.32 SQ.M



KEY SECTION

ROOF
21
20
19
18
17
16
15
14
13
12
11
10
09
08
07
06
05
04
03
02
01
PODIUM LEVEL
GROUND FLOOR
BASEMENT

KEY PLANS

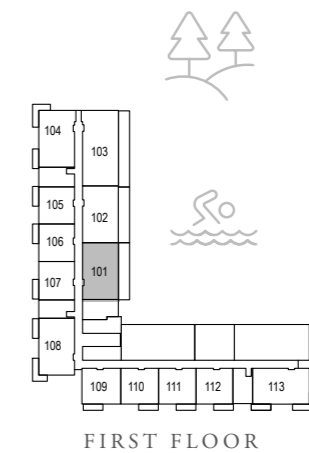

FLOOR PLAN 1. All dimensions are in imperial and metric, and measured from finish to finish excluding construction tolerances. 2. All materials, dimensions, and drawings are approximate only. 3. Information is subject to change without notice, at developer's absolute discretion. 4. Actual area may vary from the stated area. 5. Drawings not to scale. 6. All images used are for illustrative purposes only and do not represent the actual size, features, specifications, fittings, and furnishings. 7. The developer reserves the right to make revisions / alterations, at its absolute discretion, without any liability whatsoever.

PALACE

RESIDENCES DUBAI HILLS ESTATE

2 BEDROOM TYPE C.4

UNIT: 201, 301, 401, 501, 601, 701, 801, 901, 1001, 1101,
1201, 1301, 1401, 1501

SUITE AREA:	1005.46 SQ.FT	93.41 SQ.M
BALCONY AREA:	109.04 SQ.FT	10.13 SQ.M
TOTAL AREA:	1114.5 SQ.FT	103.54 SQ.M



KEY SECTION

ROOF
21
20
19
18
17
16
15
14
13
12
11
10
09
08
07
06
05
04
03
02
01
PODIUM LEVEL
GROUND FLOOR
BASEMENT

KEY PLANS

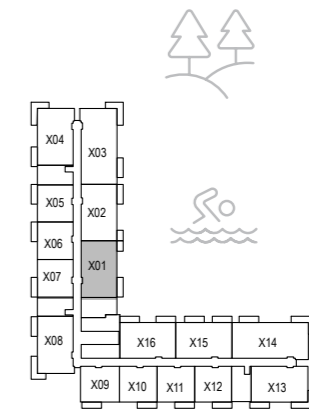

LEVELS 2 TO 15

FLOOR PLAN 1. All dimensions are in imperial and metric, and measured from finish to finish excluding construction tolerances. 2. All materials, dimensions, and drawings are approximate only. 3. Information is subject to change without notice, at developer's absolute discretion. 4. Actual area may vary from the stated area. 5. Drawings not to scale. 6. All images used are for illustrative purposes only and do not represent the actual size, features, specifications, fittings, and furnishings. 7. The developer reserves the right to make revisions / alterations, at its absolute discretion, without any liability whatsoever.

PALACE

RESIDENCES DUBAI HILLS ESTATE

2 BEDROOM TYPE D.1

UNIT: 216, 316, 416, 516, 616, 716, 816, 916, 1016, 1116,
1216, 1316, 1416, 1516

SUITE AREA:	1023.32 SQ.FT	95.07 SQ.M
BALCONY AREA:	145.96 SQ.FT	13.56 SQ.M
TOTAL AREA:	1169.28 SQ.FT	108.63 SQ.M



KEY SECTION

ROOF
21
20
19
18
17
16
15
14
13
12
11
10
09
08
07
06
05
04
03
02
01
PODIUM LEVEL
GROUND FLOOR
BASEMENT

KEY PLANS

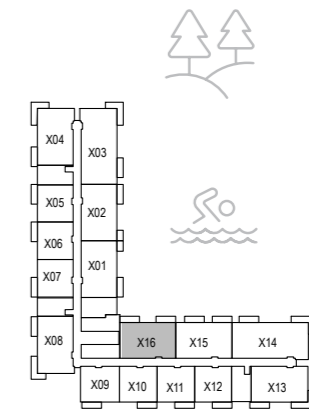

LEVELS 2 TO 15

FLOOR PLAN 1. All dimensions are in imperial and metric, and measured from finish to finish excluding construction tolerances. 2. All materials, dimensions, and drawings are approximate only. 3. Information is subject to change without notice, at developer's absolute discretion. 4. Actual area may vary from the stated area. 5. Drawings not to scale. 6. All images used are for illustrative purposes only and do not represent the actual size, features, specifications, fittings, and furnishings. 7. The developer reserves the right to make revisions / alterations, at its absolute discretion, without any liability whatsoever.

PALACE

RESIDENCES DUBAI HILLS ESTATE

2 BEDROOM TYPE E.1

UNIT: 215, 315, 415, 515, 615, 715, 815, 915, 1015, 1115,
1215, 1315, 1415, 1515

SUITE AREA:	1018.7 SQ.FT	94.64 SQ.M
BALCONY AREA:	141.22 SQ.FT	13.12 SQ.M
TOTAL AREA:	1159.92 SQ.FT	107.76 SQ.M



KEY SECTION

ROOF
21
20
19
18
17
16
15
14
13
12
11
10
09
08
07
06
05
04
03
02
01
PODIUM LEVEL
GROUND FLOOR
BASEMENT

KEY PLANS

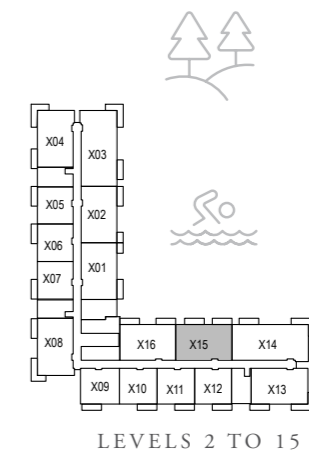

FLOOR PLAN 1. All dimensions are in imperial and metric, and measured from finish to finish excluding construction tolerances. 2. All materials, dimensions, and drawings are approximate only. 3. Information is subject to change without notice, at developer's absolute discretion. 4. Actual area may vary from the stated area. 5. Drawings not to scale. 6. All images used are for illustrative purposes only and do not represent the actual size, features, specifications, fittings, and furnishings. 7. The developer reserves the right to make revisions / alterations, at its absolute discretion, without any liability whatsoever.

PALACE

RESIDENCES DUBAI HILLS ESTATE

2 BEDROOM TYPE F.1

UNIT: 1605, 1705, 1805, 1905, 2005, 2105

SUITE AREA:	1017.08 SQ.FT	94.49 SQ.M
BALCONY AREA:	106.46 SQ.FT	9.89 SQ.M
TOTAL AREA:	1123.54 SQ.FT	104.38 SQ.M



KEY SECTION

ROOF
21
20
19
18
17
16
15
14
13
12
11
10
09
08
07
06
05
04
03
02
01
PODIUM LEVEL
GROUND FLOOR
BASEMENT

KEY PLANS

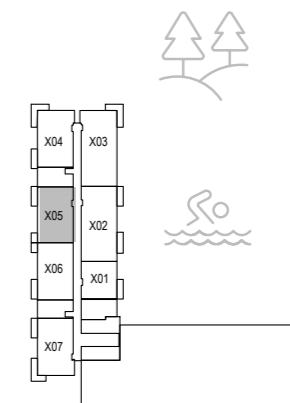

LEVELS 16 TO 21

FLOOR PLAN 1. All dimensions are in imperial and metric, and measured from finish to finish excluding construction tolerances. 2. All materials, dimensions, and drawings are approximate only. 3. Information is subject to change without notice, at developer's absolute discretion. 4. Actual area may vary from the stated area. 5. Drawings not to scale. 6. All images used are for illustrative purposes only and do not represent the actual size, features, specifications, fittings, and furnishings. 7. The developer reserves the right to make revisions / alterations, at its absolute discretion, without any liability whatsoever.

PALACE

RESIDENCES DUBAI HILLS ESTATE

2 BEDROOM TYPE G.1

UNIT: 1606, 1706, 1806, 1906, 2006, 2106

SUITE AREA:	1010.3 SQ.FT	93.86 SQ.M
BALCONY AREA:	107.85 SQ.FT	10.02 SQ.M
TOTAL AREA:	1118.16 SQ.FT	103.88 SQ.M



KEY SECTION

ROOF
21
20
19
18
17
16
15
14
13
12
11
10
09
08
07
06
05
04
03
02
01
PODIUM LEVEL
GROUND FLOOR
BASEMENT

KEY PLANS

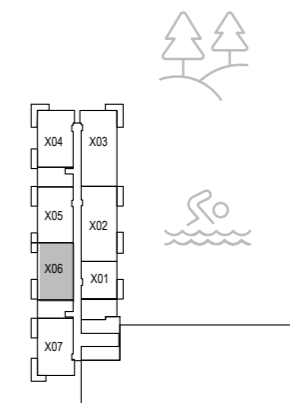

LEVELS 16 TO 21

FLOOR PLAN 1. All dimensions are in imperial and metric, and measured from finish to finish excluding construction tolerances. 2. All materials, dimensions, and drawings are approximate only. 3. Information is subject to change without notice, at developer's absolute discretion. 4. Actual area may vary from the stated area. 5. Drawings not to scale. 6. All images used are for illustrative purposes only and do not represent the actual size, features, specifications, fittings, and furnishings. 7. The developer reserves the right to make revisions / alterations, at its absolute discretion, without any liability whatsoever.

PALACE

RESIDENCES DUBAI HILLS ESTATE

3 BEDROOM TYPE A.1

UNIT: 103

SUITE AREA:	1354.42 SQ.FT	125.83 SQ.M
TERRACE AREA:	465.97 SQ.FT	43.29 SQ.M
TOTAL AREA:	1820.39 SQ.FT	169.12 SQ.M



KEY SECTION

ROOF
21
20
19
18
17
16
15
14
13
12
11
10
09
08
07
06
05
04
03
02
01
PODIUM LEVEL
GROUND FLOOR
BASEMENT

KEY PLANS

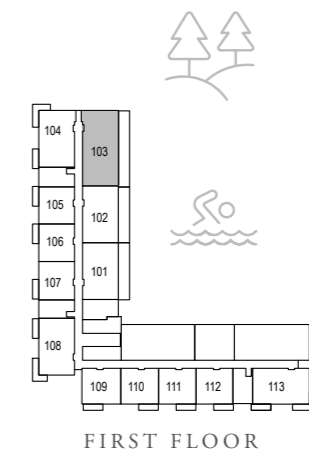

FLOOR PLAN 1. All dimensions are in imperial and metric, and measured from finish to finish excluding construction tolerances. 2. All materials, dimensions, and drawings are approximate only. 3. Information is subject to change without notice, at developer's absolute discretion. 4. Actual area may vary from the stated area. 5. Drawings not to scale. 6. All images used are for illustrative purposes only and do not represent the actual size, features, specifications, fittings, and furnishings. 7. The developer reserves the right to make revisions / alterations, at its absolute discretion, without any liability whatsoever.

PALACE

RESIDENCES DUBAI HILLS ESTATE

3 BEDROOM TYPE A.2

UNIT: 203, 303, 403, 503, 603, 703, 803, 903, 1003, 1103,
1203, 1303, 1403, 1503

SUITE AREA:	1359.27 SQ.FT	126.28 SQ.M
BALCONY AREA:	183.2 SQ.FT	17.02 SQ.M
TOTAL AREA:	1542.47 SQ.FT	143.3 SQ.M

UNIT: 1603, 1703, 1803, 1903, 2003, 2103

SUITE AREA:	1360.02 SQ.FT	126.35 SQ.M
BALCONY AREA:	183.2 SQ.FT	17.02 SQ.M
TOTAL AREA:	1543.22 SQ.FT	143.37 SQ.M



KEY SECTION

ROOF
21
20
19
18
17
16
15
14
13
12
11
10
09
08
07
06
05
04
03
02
01
PODIUM LEVEL
GROUND FLOOR
BASEMENT

KEY PLANS

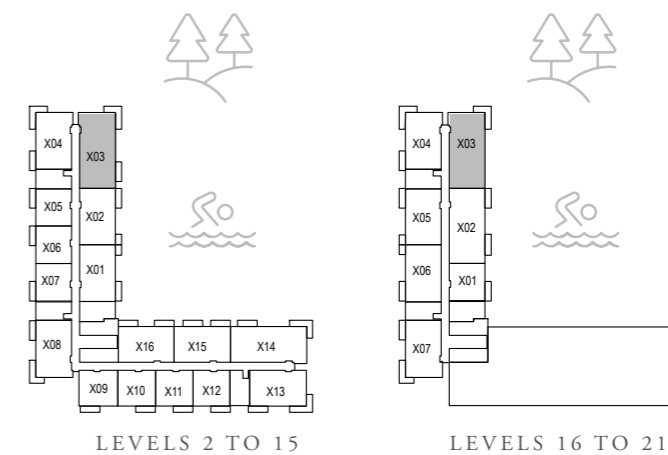

FLOOR PLAN 1. All dimensions are in imperial and metric, and measured from finish to finish excluding construction tolerances. 2. All materials, dimensions, and drawings are approximate only. 3. Information is subject to change without notice, at developer's absolute discretion. 4. Actual area may vary from the stated area. 5. Drawings not to scale. 6. All images used are for illustrative purposes only and do not represent the actual size, features, specifications, fittings, and furnishings. 7. The developer reserves the right to make revisions / alterations, at its absolute discretion, without any liability whatsoever.

PALACE

RESIDENCES DUBAI HILLS ESTATE

3 BEDROOM TYPE A.4

UNIT: 214, 314, 414, 514, 614, 714, 814, 914, 1014, 1114,
1214, 1314, 1414, 1514

SUITE AREA:	1364.00 SQ.FT	126.72 SQ.M
BALCONY AREA:	182.13 SQ.FT	16.92 SQ.M
TOTAL AREA:	1546.13 SQ.FT	143.64 SQ.M



KEY SECTION

ROOF
21
20
19
18
17
16
15
14
13
12
11
10
09
08
07
06
05
04
03
02
01
PODIUM LEVEL
GROUND FLOOR
BASEMENT

KEY PLANS

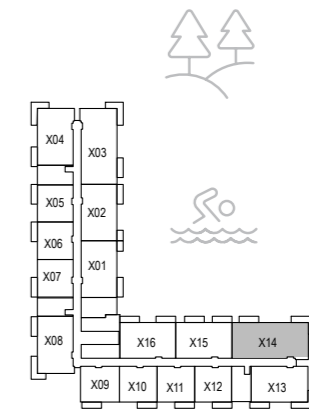

LEVELS 2 TO 15

FLOOR PLAN 1. All dimensions are in imperial and metric, and measured from finish to finish excluding construction tolerances. 2. All materials, dimensions, and drawings are approximate only. 3. Information is subject to change without notice, at developer's absolute discretion. 4. Actual area may vary from the stated area. 5. Drawings not to scale. 6. All images used are for illustrative purposes only and do not represent the actual size, features, specifications, fittings, and furnishings. 7. The developer reserves the right to make revisions / alterations, at its absolute discretion, without any liability whatsoever.

PALACE

RESIDENCES DUBAI HILLS ESTATE

3 BEDROOM TYPE B.1

UNIT: 1602, 1702, 1802, 1902, 2002, 2102

SUITE AREA:	1341.94 SQ.FT	124.67 SQ.M
BALCONY AREA:	146.17 SQ.FT	13.58 SQ.M
TOTAL AREA:	1488.11 SQ.FT	138.25 SQ.M



KEY SECTION

ROOF
21
20
19
18
17
16
15
14
13
12
11
10
09
08
07
06
05
04
03
02
01
PODIUM LEVEL
GROUND FLOOR
BASEMENT

KEY PLANS

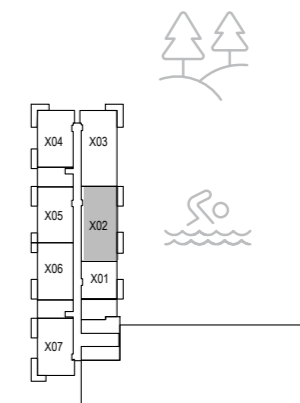

LEVELS 16 TO 21

FLOOR PLAN 1. All dimensions are in imperial and metric, and measured from finish to finish excluding construction tolerances. 2. All materials, dimensions, and drawings are approximate only. 3. Information is subject to change without notice, at developer's absolute discretion. 4. Actual area may vary from the stated area. 5. Drawings not to scale. 6. All images used are for illustrative purposes only and do not represent the actual size, features, specifications, fittings, and furnishings. 7. The developer reserves the right to make revisions / alterations, at its absolute discretion, without any liability whatsoever.

PALACE

RESIDENCES DUBAI HILLS ESTATE

TOWNHOUSE TYPE A.1

TOWNHOUSE UNITS: TH01

SUITE AREA:	2145.79 SQ.FT	199.35 SQ.M
OUTDOOR AREAS:	150.48 SQ.FT	13.98 SQ.M
TOTAL AREA:	2296.27 SQ.FT	213.33 SQ.M

TOWNHOUSE UNITS: TH03

SUITE AREA:	2152.03 SQ.FT	199.93 SQ.M
OUTDOOR AREAS:	150.48 SQ.FT	13.98 SQ.M
TOTAL AREA:	2302.51 SQ.FT	213.91 SQ.M

KEY SECTION

ROOF
21
20
19
18
17
16
15
14
13
12
11
10
09
08
07
06
05
04
03
02
01
PODIUM LEVEL
GROUND FLOOR
BASEMENT



LOWER FLOOR



UPPER FLOOR

KEY PLANS

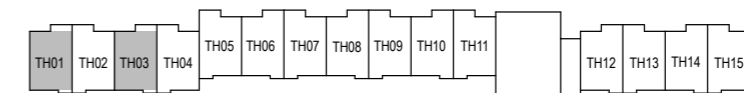

GROUND FLOOR AND PODIUM (TOWNHOUSE GF AND L01)



PALACE

RESIDENCES DUBAI HILLS ESTATE

TOWNHOUSE TYPE A.1

TOWNHOUSE UNITS: TH06, TH08, TH10, TH14

SUITE AREA:	2147.72 SQ.FT	199.53 SQ.M
OUTDOOR AREAS:	150.05 SQ.FT	13.94 SQ.M
TOTAL AREA:	2297.77 SQ.FT	213.47 SQ.M

TOWNHOUSE UNITS: TH12

SUITE AREA:	2149.77 SQ.FT	199.72 SQ.M
OUTDOOR AREAS:	150.05 SQ.FT	13.94 SQ.M
TOTAL AREA:	2299.82 SQ.FT	213.66 SQ.M

KEY SECTION

ROOF
21
20
19
18
17
16
15
14
13
12
11
10
09
08
07
06
05
04
03
02
01
PODIUM LEVEL
GROUND FLOOR
BASEMENT



LOWER FLOOR



UPPER FLOOR

KEY PLANS

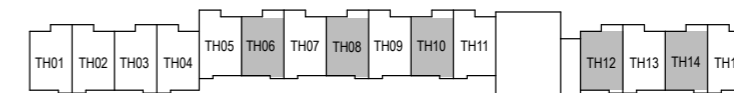

GROUND FLOOR AND PODIUM (TOWNHOUSE GF AND L01)

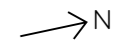

FLOOR PLAN 1. All dimensions are in imperial and metric, and measured from finish to finish excluding construction tolerances. 2. All materials, dimensions, and drawings are approximate only. 3. Information is subject to change without notice, at developer's absolute discretion. 4. Actual area may vary from the stated area. 5. Drawings not to scale. 6. All images used are for illustrative purposes only and do not represent the actual size, features, specifications, fittings, and furnishings. 7. The developer reserves the right to make revisions / alterations, at its absolute discretion, without any liability whatsoever.

PALACE

RESIDENCES DUBAI HILLS ESTATE

TOWNHOUSE TYPE A.2

TOWNHOUSE UNIT: TH02, TH07, TH09

SUITE AREA:	2147.72 SQ.FT	199.53 SQ.M
OUTDOOR AREAS:	150.05 SQ.FT	13.94 SQ.M
TOTAL AREA:	2297.77 SQ.FT	213.47 SQ.M

TOWNHOUSE UNIT: TH04

SUITE AREA:	2152.46 SQ.FT	199.97 SQ.M
OUTDOOR AREAS:	150.05 SQ.FT	13.94 SQ.M
TOTAL AREA:	2302.51 SQ.FT	213.91 SQ.M

KEY SECTION

ROOF
21
20
19
18
17
16
15
14
13
12
11
10
09
08
07
06
05
04
03
02
01
PODIUM LEVEL
GROUND FLOOR
BASEMENT



LOWER FLOOR



UPPER FLOOR

KEY PLANS



GROUND FLOOR AND PODIUM (TOWNHOUSE GF AND L01)



FLOOR PLAN 1. All dimensions are in imperial and metric, and measured from finish to finish excluding construction tolerances. 2. All materials, dimensions, and drawings are approximate only. 3. Information is subject to change without notice, at developer's absolute discretion. 4. Actual area may vary from the stated area. 5. Drawings not to scale. 6. All images used are for illustrative purposes only and do not represent the actual size, features, specifications, fittings, and furnishings. 7. The developer reserves the right to make revisions / alterations, at its absolute discretion, without any liability whatsoever.

PALACE

RESIDENCES DUBAI HILLS ESTATE

TOWNHOUSE TYPE A.2

TOWNHOUSE UNIT: TH05

SUITE AREA:	2148.91 SQ.FT	199.64 SQ.M
OUTDOOR AREAS:	147.47 SQ.FT	13.70 SQ.M
TOTAL AREA:	2296.37 SQ.FT	213.34 SQ.M

TOWNHOUSE UNIT: TH11

SUITE AREA:	2144.06 SQ.FT	199.19 SQ.M
OUTDOOR AREAS:	150.05 SQ.FT	13.94 SQ.M
TOTAL AREA:	2294.11 SQ.FT	213.13 SQ.M

KEY SECTION

ROOF
21
20
19
18
17
16
15
14
13
12
11
10
09
08
07
06
05
04
03
02
01
PODIUM LEVEL
GROUND FLOOR
BASEMENT



LOWER FLOOR



UPPER FLOOR

KEY PLANS

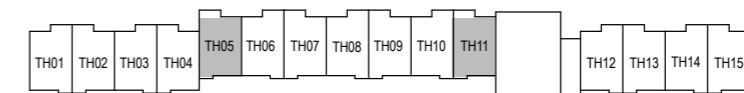

GROUND FLOOR AND PODIUM (TOWNHOUSE GF AND L01)

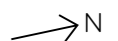

FLOOR PLAN 1. All dimensions are in imperial and metric, and measured from finish to finish excluding construction tolerances. 2. All materials, dimensions, and drawings are approximate only. 3. Information is subject to change without notice, at developer's absolute discretion. 4. Actual area may vary from the stated area. 5. Drawings not to scale. 6. All images used are for illustrative purposes only and do not represent the actual size, features, specifications, fittings, and furnishings. 7. The developer reserves the right to make revisions / alterations, at its absolute discretion, without any liability whatsoever.

PALACE

RESIDENCES DUBAI HILLS ESTATE

TOWNHOUSE TYPE A.2

TOWNHOUSE UNIT: TH13

SUITE AREA:	2147.18 SQ.FT	199.48 SQ.M
OUTDOOR AREAS:	150.59 SQ.FT	13.99 SQ.M
TOTAL AREA:	2297.77 SQ.FT	213.47 SQ.M

TOWNHOUSE UNIT: TH15

SUITE AREA:	2146.22 SQ.FT	199.39 SQ.M
OUTDOOR AREAS:	150.05 SQ.FT	13.94 SQ.M
TOTAL AREA:	2296.27 SQ.FT	213.33 SQ.M

KEY SECTION

ROOF
21
20
19
18
17
16
15
14
13
12
11
10
09
08
07
06
05
04
03
02
01
PODIUM LEVEL
GROUND FLOOR
BASEMENT



LOWER FLOOR



UPPER FLOOR

KEY PLANS

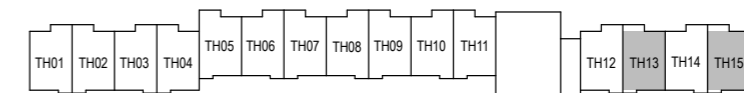

GROUND FLOOR AND PODIUM (TOWNHOUSE GF AND L01)



FLOOR PLAN 1. All dimensions are in imperial and metric, and measured from finish to finish excluding construction tolerances. 2. All materials, dimensions, and drawings are approximate only. 3. Information is subject to change without notice, at developer's absolute discretion. 4. Actual area may vary from the stated area. 5. Drawings not to scale. 6. All images used are for illustrative purposes only and do not represent the actual size, features, specifications, fittings, and furnishings. 7. The developer reserves the right to make revisions / alterations, at its absolute discretion, without any liability whatsoever.

PALACE

RESIDENCES DUBAI HILLS ESTATE

FLOOR PLANS - BUILDING 02

EMAAR

PALACE

RESIDENCES DUBAI HILLS ESTATE

1 BEDROOM TYPE A.2

UNIT: 205, 305, 405, 505, 605, 705, 805, 905, 1005, 1105,
1205, 1305, 1405, 1505, 1605, 1705

SUITE AREA:	680.71 SQ.FT	63.24 SQ.M
BALCONY AREA:	70.93 SQ.FT	6.59 SQ.M
TOTAL AREA:	751.64 SQ.FT	69.83 SQ.M

UNIT: 1901, 2001, 2101, 2201

SUITE AREA:	677.37 SQ.FT	62.93 SQ.M
BALCONY AREA:	70.93 SQ.FT	6.59 SQ.M
TOTAL AREA:	748.31 SQ.FT	69.52 SQ.M



KEY SECTION

ROOF
22
21
20
19
18
17
16
15
14
13
12
11
10
09
08
07
06
05
04
03
02
01
PODIUM LEVEL
GROUND FLOOR
BASEMENT

KEY PLANS

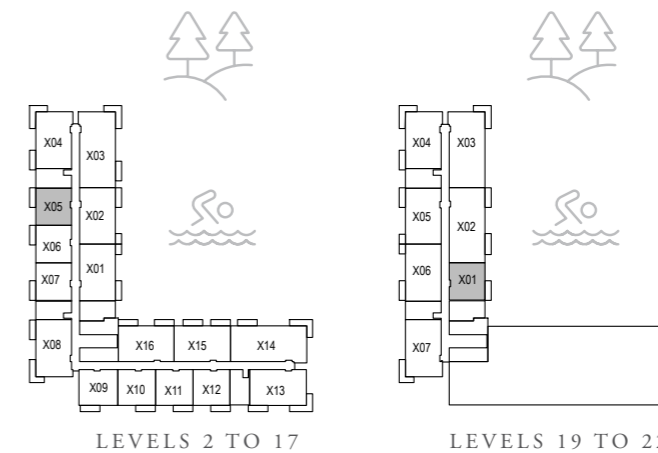

FLOOR PLAN 1. All dimensions are in imperial and metric, and measured from finish to finish excluding construction tolerances. 2. All materials, dimensions, and drawings are approximate only. 3. Information is subject to change without notice, at developer's absolute discretion. 4. Actual area may vary from the stated area. 5. Drawings not to scale. 6. All images used are for illustrative purposes only and do not represent the actual size, features, specifications, fittings, and furnishings. 7. The developer reserves the right to make revisions / alterations, at its absolute discretion, without any liability whatsoever.

PALACE

RESIDENCES DUBAI HILLS ESTATE

1 BEDROOM TYPE A.2

UNIT: P02

SUITE AREA:	681.89 SQ.FT	63.35 SQ.M
BALCONY AREA:	71.36 SQ.FT	6.63 SQ.M
TOTAL AREA:	753.26 SQ.FT	69.98 SQ.M

UNIT: 1801

SUITE AREA:	677.16 SQ.FT	62.91 SQ.M
BALCONY AREA:	70.93 SQ.FT	6.59 SQ.M
TOTAL AREA:	748.09 SQ.FT	69.50 SQ.M



KEY SECTION

ROOF
22
21
20
19
18
17
16
15
14
13
12
11
10
09
08
07
06
05
04
03
02
01
PODIUM LEVEL
GROUND FLOOR
BASEMENT

KEY PLANS

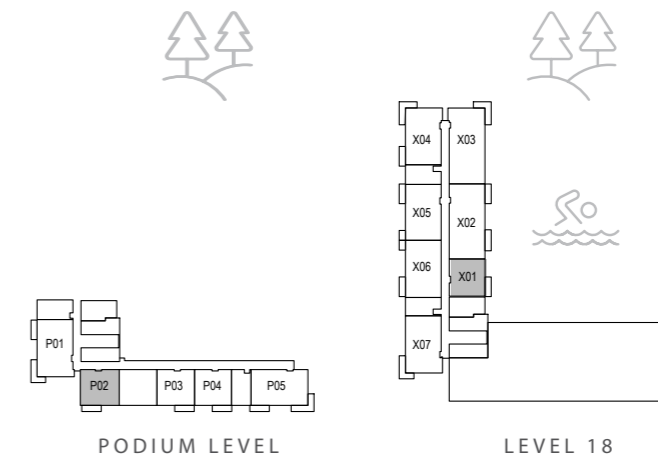

FLOOR PLAN 1. All dimensions are in imperial and metric, and measured from finish to finish excluding construction tolerances. 2. All materials, dimensions, and drawings are approximate only. 3. Information is subject to change without notice, at developer's absolute discretion. 4. Actual area may vary from the stated area. 5. Drawings not to scale. 6. All images used are for illustrative purposes only and do not represent the actual size, features, specifications, fittings, and furnishings. 7. The developer reserves the right to make revisions / alterations, at its absolute discretion, without any liability whatsoever.

PALACE

RESIDENCES DUBAI HILLS ESTATE

1 BEDROOM TYPE A.2

UNIT: 109

SUITE AREA:	682.65 SQ.FT	63.42 SQ.M
BALCONY AREA:	70.93 SQ.FT	6.59 SQ.M
TOTAL AREA:	753.58 SQ.FT	70.01 SQ.M

UNIT: 209, 309, 409, 509, 609, 709, 809, 909, 1009, 1109,
1209, 1309, 1409, 1509, 1609, 1709

SUITE AREA:	686.85 SQ.FT	63.81 SQ.M
BALCONY AREA:	70.93 SQ.FT	6.59 SQ.M
TOTAL AREA:	757.78 SQ.FT	70.40 SQ.M



KEY SECTION

ROOF
22
21
20
19
18
17
16
15
14
13
12
11
10
09
08
07
06
05
04
03
02
01
PODIUM LEVEL
GROUND FLOOR
BASEMENT

KEY PLANS

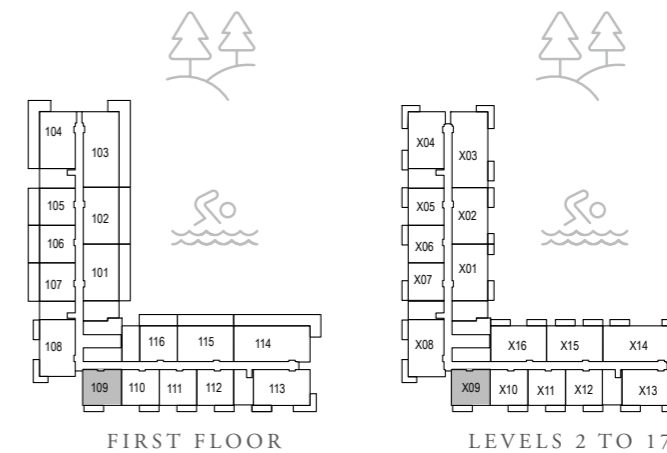

FLOOR PLAN 1. All dimensions are in imperial and metric, and measured from finish to finish excluding construction tolerances. 2. All materials, dimensions, and drawings are approximate only. 3. Information is subject to change without notice, at developer's absolute discretion. 4. Actual area may vary from the stated area. 5. Drawings not to scale. 6. All images used are for illustrative purposes only and do not represent the actual size, features, specifications, fittings, and furnishings. 7. The developer reserves the right to make revisions / alterations, at its absolute discretion, without any liability whatsoever.

PALACE

RESIDENCES DUBAI HILLS ESTATE

1 BEDROOM TYPE A.3

UNIT: 105

SUITE AREA:	680.71 SQ.FT	63.24 SQ.M
BALCONY AREA:	234.44 SQ.FT	21.78 SQ.M
TOTAL AREA:	915.15 SQ.FT	85.02 SQ.M

UNIT: 106

SUITE AREA:	676.19 SQ.FT	62.82 SQ.M
BALCONY AREA:	234.44 SQ.FT	21.78 SQ.M
TOTAL AREA:	910.63 SQ.FT	84.6 SQ.M

KEY SECTION

ROOF
22
21
20
19
18
17
16
15
14
13
12
11
10
09
08
07
06
05
04
03
02
01
PODIUM LEVEL
GROUND FLOOR
BASEMENT



KEY PLANS

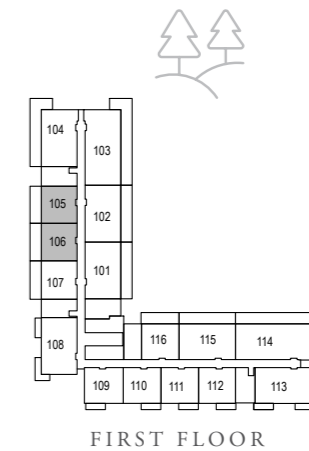

FLOOR PLAN 1. All dimensions are in imperial and metric, and measured from finish to finish excluding construction tolerances. 2. All materials, dimensions, and drawings are approximate only. 3. Information is subject to change without notice, at developer's absolute discretion. 4. Actual area may vary from the stated area. 5. Drawings not to scale. 6. All images used are for illustrative purposes only and do not represent the actual size, features, specifications, fittings, and furnishings. 7. The developer reserves the right to make revisions / alterations, at its absolute discretion, without any liability whatsoever.

PALACE

RESIDENCES DUBAI HILLS ESTATE

1 BEDROOM TYPE A.3

UNIT: 116

SUITE AREA:	676.94 SQ.FT	62.89 SQ.M
BALCONY AREA:	234.44 SQ.FT	21.78 SQ.M
TOTAL AREA:	911.38 SQ.FT	84.67 SQ.M



KEY SECTION

ROOF
22
21
20
19
18
17
16
15
14
13
12
11
10
09
08
07
06
05
04
03
02
01
PODIUM LEVEL
GROUND FLOOR
BASEMENT

KEY PLANS

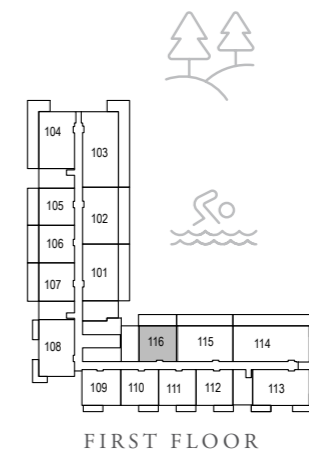

FLOOR PLAN 1. All dimensions are in imperial and metric, and measured from finish to finish excluding construction tolerances. 2. All materials, dimensions, and drawings are approximate only. 3. Information is subject to change without notice, at developer's absolute discretion. 4. Actual area may vary from the stated area. 5. Drawings not to scale. 6. All images used are for illustrative purposes only and do not represent the actual size, features, specifications, fittings, and furnishings. 7. The developer reserves the right to make revisions / alterations, at its absolute discretion, without any liability whatsoever.

PALACE

RESIDENCES DUBAI HILLS ESTATE

1 BEDROOM TYPE A.5

UNIT: P03, 111, 206, 306, 406, 506, 606, 706, 806, 906,
1006, 1106, 1206, 1306, 1406, 1506, 1606, 1706

SUITE AREA:	676.19 SQ.FT	62.82 SQ.M
BALCONY AREA:	70.93 SQ.FT	6.59 SQ.M
TOTAL AREA:	747.12 SQ.FT	69.41 SQ.M

UNIT: 207, 307, 407, 507, 607, 707, 807, 907, 1007, 1107,
1207, 1307, 1407, 1507, 1607, 1707

SUITE AREA:	679.31 SQ.FT	63.11 SQ.M
BALCONY AREA:	72.23 SQ.FT	6.71 SQ.M
TOTAL AREA:	751.54 SQ.FT	69.82 SQ.M



KEY SECTION

ROOF
22
21
20
19
18
17
16
15
14
13
12
11
10
09
08
07
06
05
04
03
02
01
PODIUM LEVEL
GROUND FLOOR
BASEMENT

KEY PLANS

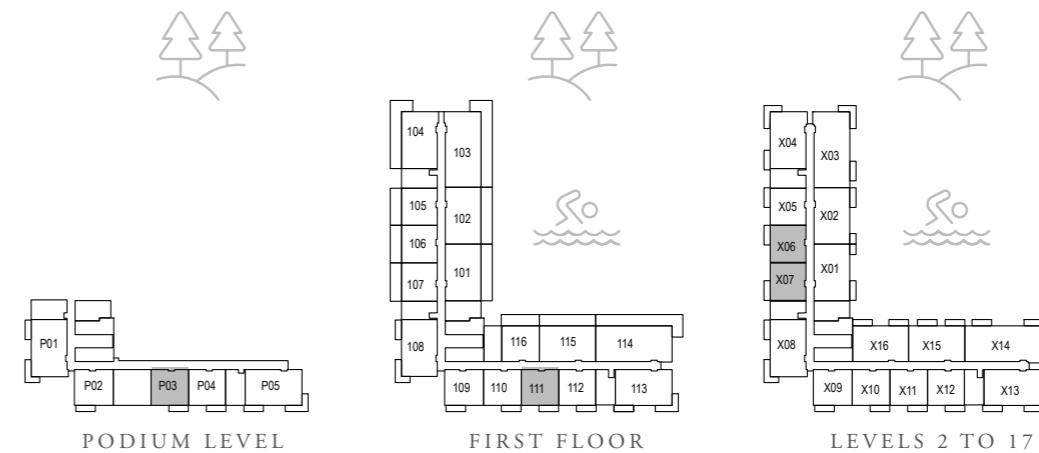

FLOOR PLAN 1. All dimensions are in imperial and metric, and measured from finish to finish excluding construction tolerances. 2. All materials, dimensions, and drawings are approximate only. 3. Information is subject to change without notice, at developer's absolute discretion. 4. Actual area may vary from the stated area. 5. Drawings not to scale. 6. All images used are for illustrative purposes only and do not represent the actual size, features, specifications, fittings, and furnishings. 7. The developer reserves the right to make revisions / alterations, at its absolute discretion, without any liability whatsoever.

PALACE

RESIDENCES DUBAI HILLS ESTATE

1 BEDROOM TYPE A.5

UNIT: 210, 310, 410, 510, 610, 710, 810, 910, 1010, 1110,
1210, 1310, 1410, 1510, 1610, 1710

SUITE AREA:	672.31 SQ.FT	62.46 SQ.M
BALCONY AREA:	70.93 SQ.FT	6.59 SQ.M
TOTAL AREA:	743.25 SQ.FT	69.05 SQ.M

UNIT: 110

SUITE AREA:	680.28 SQ.FT	63.20 SQ.M
BALCONY AREA:	70.93 SQ.FT	6.59 SQ.M
TOTAL AREA:	751.21 SQ.FT	69.79 SQ.M



KEY SECTION

ROOF
22
21
20
19
18
17
16
15
14
13
12
11
10
09
08
07
06
05
04
03
02
01
PODIUM LEVEL
GROUND FLOOR
BASEMENT

KEY PLANS

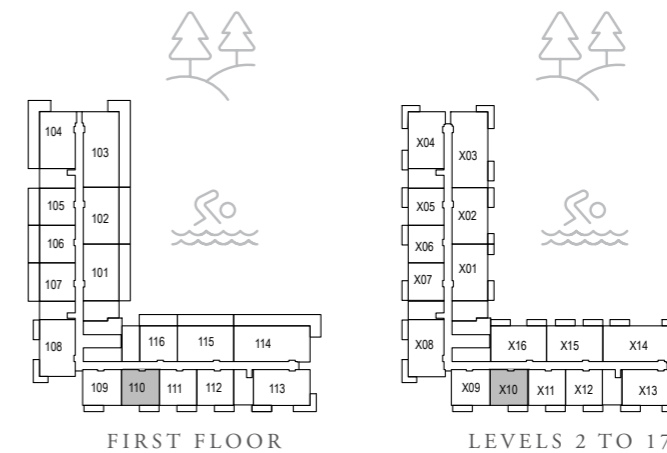

FLOOR PLAN 1. All dimensions are in imperial and metric, and measured from finish to finish excluding construction tolerances. 2. All materials, dimensions, and drawings are approximate only. 3. Information is subject to change without notice, at developer's absolute discretion. 4. Actual area may vary from the stated area. 5. Drawings not to scale. 6. All images used are for illustrative purposes only and do not represent the actual size, features, specifications, fittings, and furnishings. 7. The developer reserves the right to make revisions / alterations, at its absolute discretion, without any liability whatsoever.

PALACE

RESIDENCES DUBAI HILLS ESTATE

1 BEDROOM TYPE A.5

UNIT: P04, 112, 212, 312, 412, 512, 612, 712, 812, 912,
1012, 1112, 1212, 1312, 1412, 1512, 1612, 1712

SUITE AREA:	676.51 SQ.FT	62.85 SQ.M
BALCONY AREA:	70.93 SQ.FT	6.59 SQ.M
TOTAL AREA:	747.45 SQ.FT	69.44 SQ.M

UNIT: 211, 311, 411, 511, 611, 711, 811, 911, 1011, 1111,
1211, 1311, 1411, 1511, 1611, 1711

SUITE AREA:	680.39 SQ.FT	63.21 SQ.M
BALCONY AREA:	70.93 SQ.FT	6.59 SQ.M
TOTAL AREA:	751.32 SQ.FT	69.80 SQ.M



KEY SECTION

ROOF
22
21
20
19
18
17
16
15
14
13
12
11
10
09
08
07
06
05
04
03
02
01
PODIUM LEVEL
GROUND FLOOR
BASEMENT

KEY PLANS

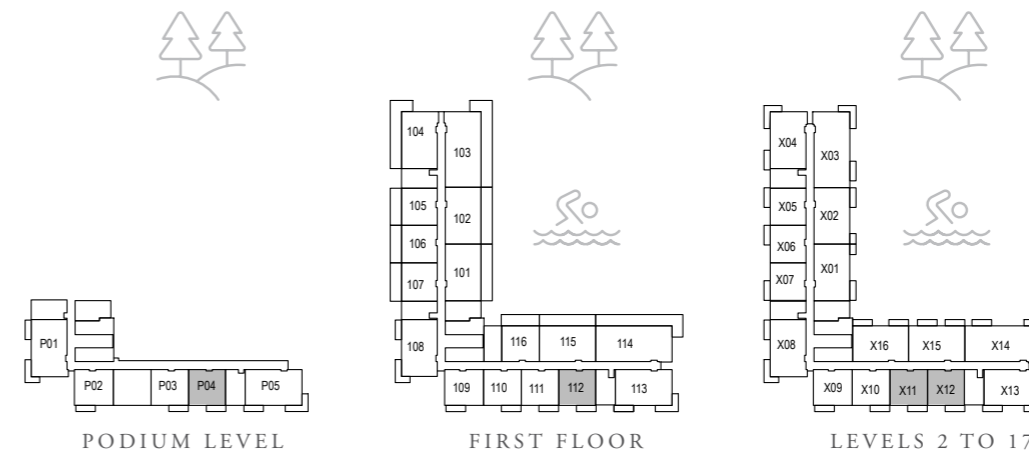

FLOOR PLAN 1. All dimensions are in imperial and metric, and measured from finish to finish excluding construction tolerances. 2. All materials, dimensions, and drawings are approximate only. 3. Information is subject to change without notice, at developer's absolute discretion. 4. Actual area may vary from the stated area. 5. Drawings not to scale. 6. All images used are for illustrative purposes only and do not represent the actual size, features, specifications, fittings, and furnishings. 7. The developer reserves the right to make revisions / alterations, at its absolute discretion, without any liability whatsoever.

PALACE

RESIDENCES DUBAI HILLS ESTATE

1 BEDROOM TYPE A.6

UNIT: 107

SUITE AREA:	679.31 SQ.FT	63.11 SQ.M
BALCONY AREA:	235.84 SQ.FT	21.91 SQ.M
TOTAL AREA:	915.15 SQ.FT	85.02 SQ.M



KEY SECTION

ROOF
22
21
20
19
18
17
16
15
14
13
12
11
10
09
08
07
06
05
04
03
02
01
PODIUM LEVEL
GROUND FLOOR
BASEMENT

KEY PLANS

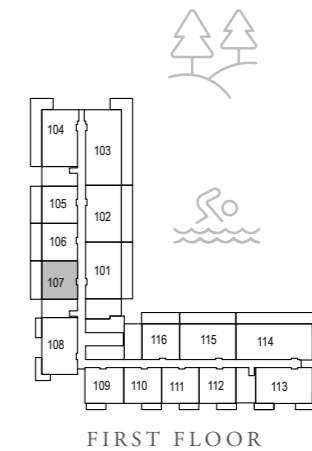

FLOOR PLAN 1. All dimensions are in imperial and metric, and measured from finish to finish excluding construction tolerances. 2. All materials, dimensions, and drawings are approximate only. 3. Information is subject to change without notice, at developer's absolute discretion. 4. Actual area may vary from the stated area. 5. Drawings not to scale. 6. All images used are for illustrative purposes only and do not represent the actual size, features, specifications, fittings, and furnishings. 7. The developer reserves the right to make revisions / alterations, at its absolute discretion, without any liability whatsoever.

PALACE

RESIDENCES DUBAI HILLS ESTATE

2 BEDROOM TYPE A.2

UNIT: 204, 304, 404, 504, 604, 704, 804, 904, 1004, 1104,
1204, 1304, 1404, 1504, 1604, 1704

SUITE AREA:	1037.64 SQ.FT	96.4 SQ.M
BALCONY AREA:	183.85 SQ.FT	17.08 SQ.M
TOTAL AREA:	1221.49 SQ.FT	113.48 SQ.M

UNIT: 1804, 1904, 2004, 2104, 2204

SUITE AREA:	1036.46 SQ.FT	96.29 SQ.M
BALCONY AREA:	185.14 SQ.FT	17.2 SQ.M
TOTAL AREA:	1221.6 SQ.FT	113.49 SQ.M



KEY SECTION

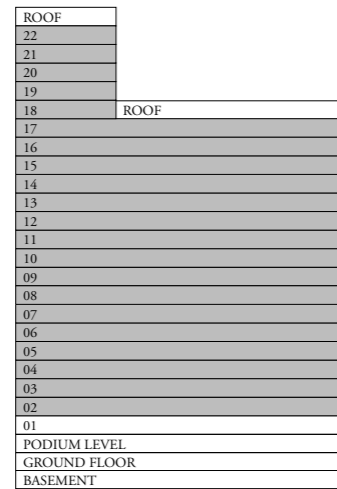

KEY PLANS

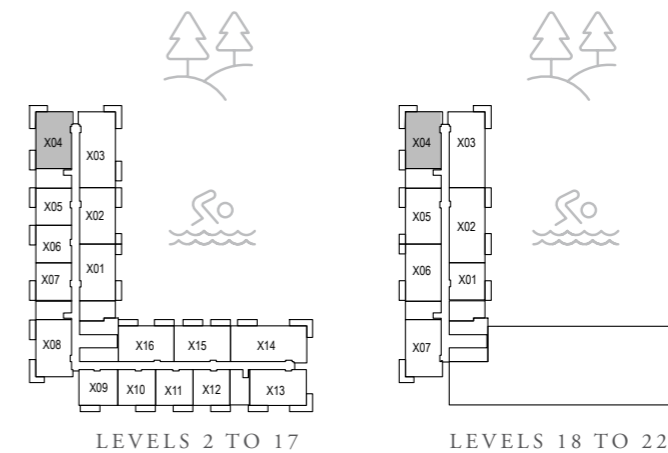

FLOOR PLAN 1. All dimensions are in imperial and metric, and measured from finish to finish excluding construction tolerances. 2. All materials, dimensions, and drawings are approximate only. 3. Information is subject to change without notice, at developer's absolute discretion. 4. Actual area may vary from the stated area. 5. Drawings not to scale. 6. All images used are for illustrative purposes only and do not represent the actual size, features, specifications, fittings, and furnishings. 7. The developer reserves the right to make revisions / alterations, at its absolute discretion, without any liability whatsoever.

PALACE

RESIDENCES DUBAI HILLS ESTATE

2 BEDROOM TYPE A.3

UNIT: 104

SUITE AREA:	1035.38 SQ.FT	96.19 SQ.M
BALCONY AREA:	479.53 SQ.FT	44.55 SQ.M
TOTAL AREA:	1514.91 SQ.FT	140.74 SQ.M



KEY SECTION

ROOF
22
21
20
19
18
17
16
15
14
13
12
11
10
09
08
07
06
05
04
03
02
01
PODIUM LEVEL
GROUND FLOOR
BASEMENT

KEY PLANS

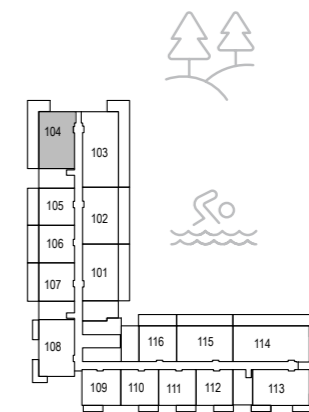

FIRST FLOOR

FLOOR PLAN 1. All dimensions are in imperial and metric, and measured from finish to finish excluding construction tolerances. 2. All materials, dimensions, and drawings are approximate only. 3. Information is subject to change without notice, at developer's absolute discretion. 4. Actual area may vary from the stated area. 5. Drawings not to scale. 6. All images used are for illustrative purposes only and do not represent the actual size, features, specifications, fittings, and furnishings. 7. The developer reserves the right to make revisions / alterations, at its absolute discretion, without any liability whatsoever.

PALACE

RESIDENCES DUBAI HILLS ESTATE

2 BEDROOM TYPE A.4

UNIT: P05

SUITE AREA:	1036.03 SQ.FT	96.25 SQ.M
BALCONY AREA:	183.09 SQ.FT	17.01 SQ.M
TOTAL AREA:	1219.12 SQ.FT	113.26 SQ.M

UNIT: 113

SUITE AREA:	1035.6 SQ.FT	96.21 SQ.M
BALCONY AREA:	183.74 SQ.FT	17.07 SQ.M
TOTAL AREA:	1219.34 SQ.FT	113.28 SQ.M



KEY SECTION

ROOF
22
21
20
19
18
17
16
15
14
13
12
11
10
09
08
07
06
05
04
03
02
01
PODIUM LEVEL
GROUND FLOOR
BASEMENT

KEY PLANS

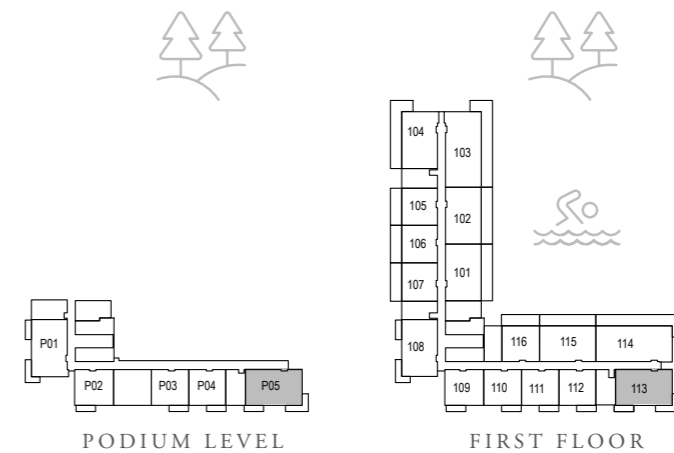

FLOOR PLAN 1. All dimensions are in imperial and metric, and measured from finish to finish excluding construction tolerances. 2. All materials, dimensions, and drawings are approximate only. 3. Information is subject to change without notice, at developer's absolute discretion. 4. Actual area may vary from the stated area. 5. Drawings not to scale. 6. All images used are for illustrative purposes only and do not represent the actual size, features, specifications, fittings, and furnishings. 7. The developer reserves the right to make revisions / alterations, at its absolute discretion, without any liability whatsoever.

PALACE

RESIDENCES DUBAI HILLS ESTATE

2 BEDROOM TYPE A.4

UNIT: 213, 313, 413, 513, 613, 713, 813, 913, 1013, 1113,
1213, 1313, 1413, 1513, 1613, 1713

SUITE AREA:	1034.73 SQ.FT	96.13 SQ.M
BALCONY AREA:	183.74 SQ.FT	17.07 SQ.M
TOTAL AREA:	1218.47 SQ.FT	113.20 SQ.M



KEY SECTION

ROOF
22
21
20
19
18
17
16
15
14
13
12
11
10
09
08
07
06
05
04
03
02
01
PODIUM LEVEL
GROUND FLOOR
BASEMENT

KEY PLANS

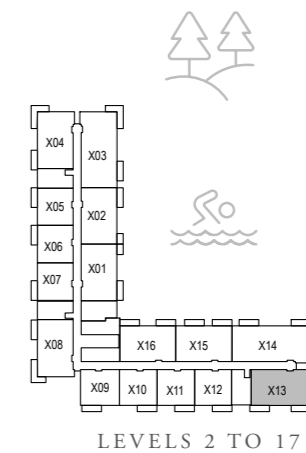

FLOOR PLAN 1. All dimensions are in imperial and metric, and measured from finish to finish excluding construction tolerances. 2. All materials, dimensions, and drawings are approximate only. 3. Information is subject to change without notice, at developer's absolute discretion. 4. Actual area may vary from the stated area. 5. Drawings not to scale. 6. All images used are for illustrative purposes only and do not represent the actual size, features, specifications, fittings, and furnishings. 7. The developer reserves the right to make revisions / alterations, at its absolute discretion, without any liability whatsoever.

PALACE

RESIDENCES DUBAI HILLS ESTATE

2 BEDROOM TYPE B.2

UNIT: P01

SUITE AREA:	1030.21 SQ.FT	95.71 SQ.M
BALCONY AREA:	174.16 SQ.FT	16.18 SQ.M
TOTAL AREA:	1204.37 SQ.FT	111.89 SQ.M
UNIT: 208, 308, 408, 508, 608, 708, 808, 908, 1008, 1108, 1208, 1308, 1408, 1508, 1608, 1708		
SUITE AREA:	1033.23 SQ.FT	95.99 SQ.M
BALCONY AREA:	173.84 SQ.FT	16.15 SQ.M
TOTAL AREA:	1207.06 SQ.FT	112.14 SQ.M



KEY SECTION

ROOF
22
21
20
19
18
17
16
15
14
13
12
11
10
09
08
07
06
05
04
03
02
01
PODIUM LEVEL
GROUND FLOOR
BASEMENT

KEY PLANS

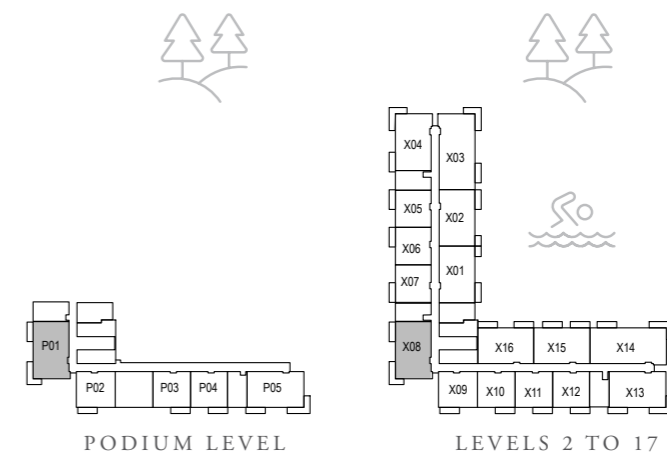

FLOOR PLAN 1. All dimensions are in imperial and metric, and measured from finish to finish excluding construction tolerances. 2. All materials, dimensions, and drawings are approximate only. 3. Information is subject to change without notice, at developer's absolute discretion. 4. Actual area may vary from the stated area. 5. Drawings not to scale. 6. All images used are for illustrative purposes only and do not represent the actual size, features, specifications, fittings, and furnishings. 7. The developer reserves the right to make revisions / alterations, at its absolute discretion, without any liability whatsoever.

PALACE

RESIDENCES DUBAI HILLS ESTATE

2 BEDROOM TYPE B.2

UNIT: 1807, 1907, 2007, 2107, 2207

SUITE AREA:	1033.87 SQ.FT	96.05 SQ.M
BALCONY AREA:	173.84 SQ.FT	16.15 SQ.M
TOTAL AREA:	1207.71 SQ.FT	112.2 SQ.M



KEY SECTION

ROOF
22
21
20
19
18
17
16
15
14
13
12
11
10
09
08
07
06
05
04
03
02
01
PODIUM LEVEL
GROUND FLOOR
BASEMENT

KEY PLANS

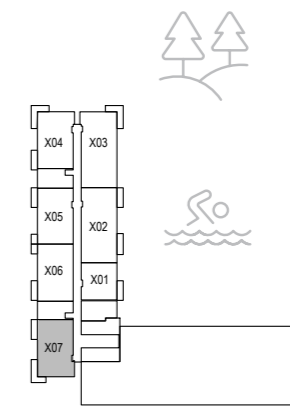

LEVELS 18 TO 22

FLOOR PLAN 1. All dimensions are in imperial and metric, and measured from finish to finish excluding construction tolerances. 2. All materials, dimensions, and drawings are approximate only. 3. Information is subject to change without notice, at developer's absolute discretion. 4. Actual area may vary from the stated area. 5. Drawings not to scale. 6. All images used are for illustrative purposes only and do not represent the actual size, features, specifications, fittings, and furnishings. 7. The developer reserves the right to make revisions / alterations, at its absolute discretion, without any liability whatsoever.

PALACE

RESIDENCES DUBAI HILLS ESTATE

2 BEDROOM TYPE B.3

UNIT: 108

SUITE AREA:	1031.94 SQ.FT	95.87 SQ.M
BALCONY AREA:	217.11 SQ.FT	20.17 SQ.M
TOTAL AREA:	1249.04 SQ.FT	116.04 SQ.M



KEY SECTION

ROOF
22
21
20
19
18
17
16
15
14
13
12
11
10
09
08
07
06
05
04
03
02
01
PODIUM LEVEL
GROUND FLOOR
BASEMENT

KEY PLANS

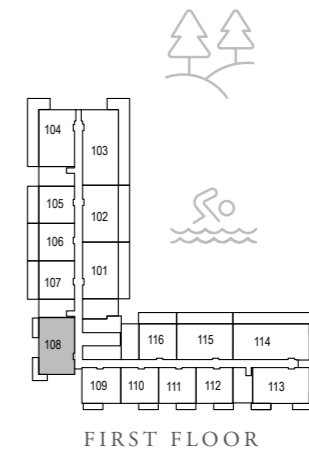

FLOOR PLAN 1. All dimensions are in imperial and metric, and measured from finish to finish excluding construction tolerances. 2. All materials, dimensions, and drawings are approximate only. 3. Information is subject to change without notice, at developer's absolute discretion. 4. Actual area may vary from the stated area. 5. Drawings not to scale. 6. All images used are for illustrative purposes only and do not represent the actual size, features, specifications, fittings, and furnishings. 7. The developer reserves the right to make revisions / alterations, at its absolute discretion, without any liability whatsoever.

PALACE

RESIDENCES DUBAI HILLS ESTATE

2 BEDROOM TYPE C.1

UNIT: 102

SUITE AREA:	1011.92 SQ.FT	94.01 SQ.M
TERRACE AREA:	352.63 SQ.FT	32.76 SQ.M
TOTAL AREA:	1364.54 SQ.FT	126.77 SQ.M



KEY SECTION

ROOF
22
21
20
19
18
17
16
15
14
13
12
11
10
09
08
07
06
05
04
03
02
01
PODIUM LEVEL
GROUND FLOOR
BASEMENT

KEY PLANS

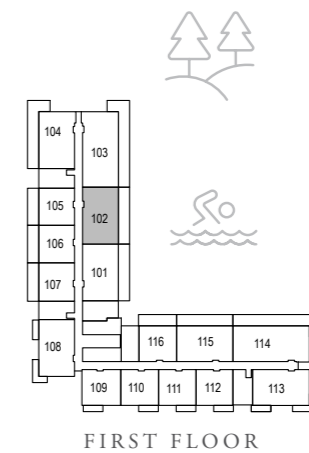

FLOOR PLAN 1. All dimensions are in imperial and metric, and measured from finish to finish excluding construction tolerances. 2. All materials, dimensions, and drawings are approximate only. 3. Information is subject to change without notice, at developer's absolute discretion. 4. Actual area may vary from the stated area. 5. Drawings not to scale. 6. All images used are for illustrative purposes only and do not represent the actual size, features, specifications, fittings, and furnishings. 7. The developer reserves the right to make revisions / alterations, at its absolute discretion, without any liability whatsoever.

PALACE

RESIDENCES DUBAI HILLS ESTATE

2 BEDROOM TYPE C.2

UNIT: 202, 302, 402, 502, 602, 702, 802, 902, 1002, 1102,
1202, 1302, 1402, 1502, 1602, 1702

SUITE AREA:	1009.65 SQ.FT	93.8 SQ.M
BALCONY AREA:	106.46 SQ.FT	9.89 SQ.M
TOTAL AREA:	1116.11 SQ.FT	103.69 SQ.M



KEY SECTION

ROOF
22
21
20
19
18
17
16
15
14
13
12
11
10
09
08
07
06
05
04
03
02
01
PODIUM LEVEL
GROUND FLOOR
BASEMENT

KEY PLANS

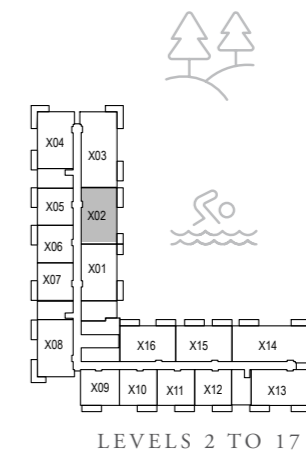

PALACE

RESIDENCES DUBAI HILLS ESTATE

2 BEDROOM TYPE C.3

UNIT: 101

SUITE AREA:	1005.67 SQ.FT	93.43 SQ.M
TERRACE AREA:	354.03 SQ.FT	32.89 SQ.M
TOTAL AREA:	1359.7 SQ.FT	126.32 SQ.M



KEY SECTION

ROOF
22
21
20
19
18
17
16
15
14
13
12
11
10
09
08
07
06
05
04
03
02
01
PODIUM LEVEL
GROUND FLOOR
BASEMENT

KEY PLANS

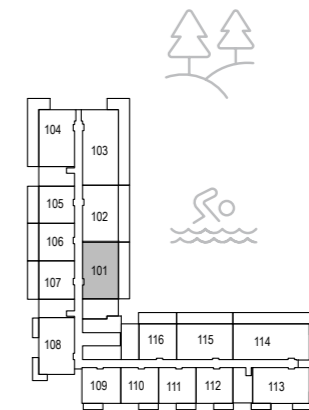

FIRST FLOOR

FLOOR PLAN 1. All dimensions are in imperial and metric, and measured from finish to finish excluding construction tolerances. 2. All materials, dimensions, and drawings are approximate only. 3. Information is subject to change without notice, at developer's absolute discretion. 4. Actual area may vary from the stated area. 5. Drawings not to scale. 6. All images used are for illustrative purposes only and do not represent the actual size, features, specifications, fittings, and furnishings. 7. The developer reserves the right to make revisions / alterations, at its absolute discretion, without any liability whatsoever.

PALACE

RESIDENCES DUBAI HILLS ESTATE

2 BEDROOM TYPE C.4

UNIT: 201, 301, 401, 501, 601, 701, 801, 901, 1001, 1101,
1201, 1301, 1401, 1501, 1601, 1701

SUITE AREA:	1005.67 SQ.FT	93.43 SQ.M
BALCONY AREA:	106.56 SQ.FT	9.90 SQ.M
TOTAL AREA:	1112.23 SQ.FT	103.33 SQ.M



KEY SECTION

ROOF
22
21
20
19
18
17
16
15
14
13
12
11
10
09
08
07
06
05
04
03
02
01
PODIUM LEVEL
GROUND FLOOR
BASEMENT

KEY PLANS

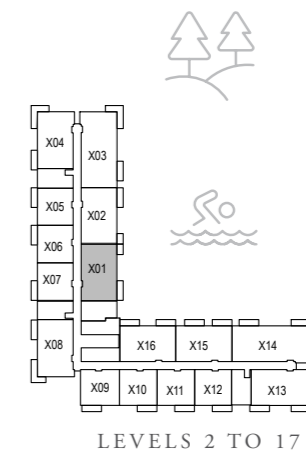

PALACE

RESIDENCES DUBAI HILLS ESTATE

2 BEDROOM TYPE D.1

UNIT: 216, 316, 416, 516, 616, 716, 816, 916, 1016, 1116,
1216, 1316, 1416, 1516, 1616, 1716

SUITE AREA:	1023.32 SQ.FT	95.07 SQ.M
BALCONY AREA:	145.96 SQ.FT	13.56 SQ.M
TOTAL AREA:	1169.28 SQ.FT	108.63 SQ.M



KEY SECTION

ROOF
22
21
20
19
18
17
16
15
14
13
12
11
10
09
08
07
06
05
04
03
02
01
PODIUM LEVEL
GROUND FLOOR
BASEMENT

KEY PLANS

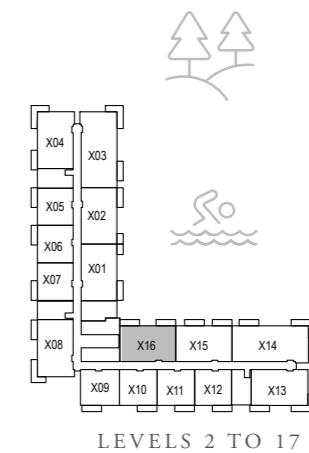

PALACE

RESIDENCES DUBAI HILLS ESTATE

2 BEDROOM TYPE E.1

UNIT: 215, 315, 415, 515, 615, 715, 815, 915, 1015, 1115,
1215, 1315, 1415, 1515, 1615, 1715

SUITE AREA:	1018.7 SQ.FT	94.64 SQ.M
BALCONY AREA:	141.22 SQ.FT	13.12 SQ.M
TOTAL AREA:	1159.92 SQ.FT	107.76 SQ.M



KEY SECTION

ROOF
22
21
20
19
18
17
16
15
14
13
12
11
10
09
08
07
06
05
04
03
02
01
PODIUM LEVEL
GROUND FLOOR
BASEMENT

KEY PLANS

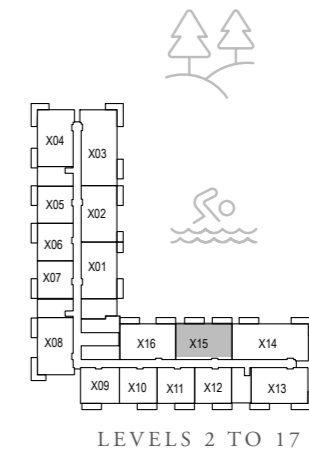

FLOOR PLAN 1. All dimensions are in imperial and metric, and measured from finish to finish excluding construction tolerances. 2. All materials, dimensions, and drawings are approximate only. 3. Information is subject to change without notice, at developer's absolute discretion. 4. Actual area may vary from the stated area. 5. Drawings not to scale. 6. All images used are for illustrative purposes only and do not represent the actual size, features, specifications, fittings, and furnishings. 7. The developer reserves the right to make revisions / alterations, at its absolute discretion, without any liability whatsoever.

PALACE

RESIDENCES DUBAI HILLS ESTATE

2 BEDROOM TYPE E.2

UNIT: 115

SUITE AREA:	1018.7 SQ.FT	94.64 SQ.M
BALCONY AREA:	353.06 SQ.FT	32.8 SQ.M
TOTAL AREA:	1371.75 SQ.FT	127.44 SQ.M



KEY SECTION

ROOF
22
21
20
19
18
17
16
15
14
13
12
11
10
09
08
07
06
05
04
03
02
01
PODIUM LEVEL
GROUND FLOOR
BASEMENT

KEY PLANS

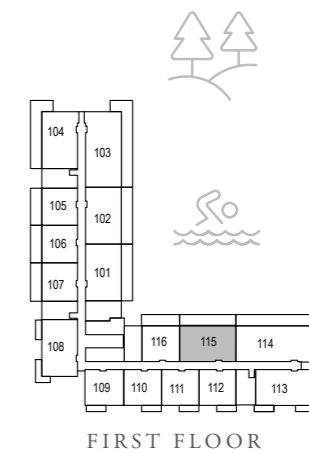

FLOOR PLAN 1. All dimensions are in imperial and metric, and measured from finish to finish excluding construction tolerances. 2. All materials, dimensions, and drawings are approximate only. 3. Information is subject to change without notice, at developer's absolute discretion. 4. Actual area may vary from the stated area. 5. Drawings not to scale. 6. All images used are for illustrative purposes only and do not represent the actual size, features, specifications, fittings, and furnishings. 7. The developer reserves the right to make revisions / alterations, at its absolute discretion, without any liability whatsoever.

PALACE

RESIDENCES DUBAI HILLS ESTATE

2 BEDROOM TYPE F.1

UNIT: 1805, 1905, 2005, 2105, 2205

SUITE AREA:	1013.42 SQ.FT	94.15 SQ.M
BALCONY AREA:	108.82 SQ.FT	10.11 SQ.M
TOTAL AREA:	1122.25 SQ.FT	104.26 SQ.M



KEY SECTION

ROOF
22
21
20
19
18
17
16
15
14
13
12
11
10
09
08
07
06
05
04
03
02
01
PODIUM LEVEL
GROUND FLOOR
BASEMENT

KEY PLANS

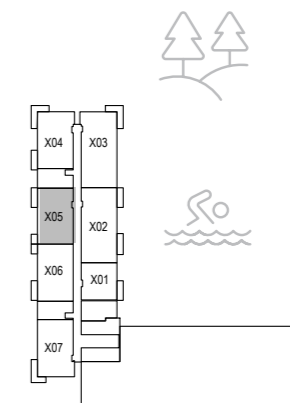

LEVELS 18 TO 22

FLOOR PLAN 1. All dimensions are in imperial and metric, and measured from finish to finish excluding construction tolerances. 2. All materials, dimensions, and drawings are approximate only. 3. Information is subject to change without notice, at developer's absolute discretion. 4. Actual area may vary from the stated area. 5. Drawings not to scale. 6. All images used are for illustrative purposes only and do not represent the actual size, features, specifications, fittings, and furnishings. 7. The developer reserves the right to make revisions / alterations, at its absolute discretion, without any liability whatsoever.

PALACE

RESIDENCES DUBAI HILLS ESTATE

2 BEDROOM TYPE G.1

UNIT: 1806, 1906, 2006, 2106, 2206

SUITE AREA:	1008.04 SQ.FT	93.65 SQ.M
BALCONY AREA:	108.72 SQ.FT	10.10 SQ.M
TOTAL AREA:	1116.76 SQ.FT	103.75 SQ.M



KEY SECTION

ROOF
22
21
20
19
18
17
16
15
14
13
12
11
10
09
08
07
06
05
04
03
02
01
PODIUM LEVEL
GROUND FLOOR
BASEMENT

KEY PLANS

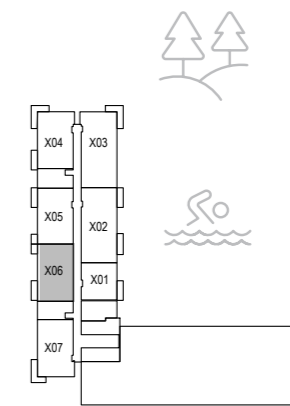

LEVELS 18 TO 22

FLOOR PLAN 1. All dimensions are in imperial and metric, and measured from finish to finish excluding construction tolerances. 2. All materials, dimensions, and drawings are approximate only. 3. Information is subject to change without notice, at developer's absolute discretion. 4. Actual area may vary from the stated area. 5. Drawings not to scale. 6. All images used are for illustrative purposes only and do not represent the actual size, features, specifications, fittings, and furnishings. 7. The developer reserves the right to make revisions / alterations, at its absolute discretion, without any liability whatsoever.

PALACE

RESIDENCES DUBAI HILLS ESTATE

3 BEDROOM TYPE A.2

UNIT: 203, 303, 403, 503, 603, 703, 803, 903, 1003, 1103,
1203, 1303, 1403, 1503, 1603, 1703

SUITE AREA:	1361.85 SQ.FT	126.52 SQ.M
BALCONY AREA:	183.2 SQ.FT	17.02 SQ.M
TOTAL AREA:	1545.05 SQ.FT	143.54 SQ.M

UNIT: 1803, 1903, 2003, 2103, 2203

SUITE AREA:	1362.07 SQ.FT	126.54 SQ.M
BALCONY AREA:	183.2 SQ.FT	17.02 SQ.M
TOTAL AREA:	1545.27 SQ.FT	143.56 SQ.M



KEY SECTION

ROOF
22
21
20
19
18
17
16
15
14
13
12
11
10
09
08
07
06
05
04
03
02
01
PODIUM LEVEL
GROUND FLOOR
BASEMENT

KEY PLANS

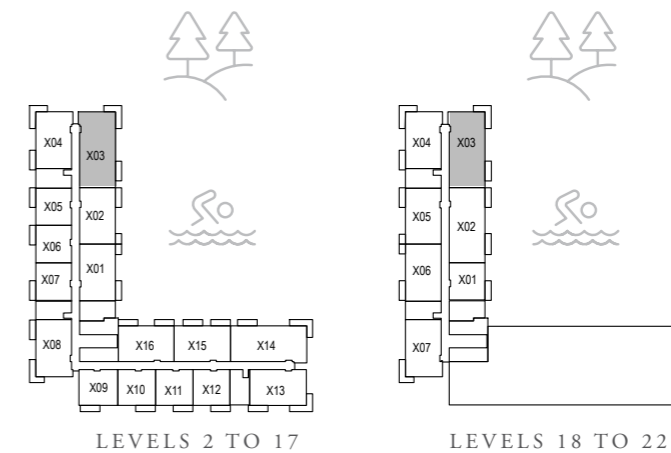

FLOOR PLAN 1. All dimensions are in imperial and metric, and measured from finish to finish excluding construction tolerances. 2. All materials, dimensions, and drawings are approximate only. 3. Information is subject to change without notice, at developer's absolute discretion. 4. Actual area may vary from the stated area. 5. Drawings not to scale. 6. All images used are for illustrative purposes only and do not represent the actual size, features, specifications, fittings, and furnishings. 7. The developer reserves the right to make revisions / alterations, at its absolute discretion, without any liability whatsoever.

PALACE

RESIDENCES DUBAI HILLS ESTATE

3 BEDROOM TYPE A.3

UNIT: 103

SUITE AREA:	1357.01 SQ.FT	126.07 SQ.M
BALCONY AREA:	596.43 SQ.FT	55.41 SQ.M
TOTAL AREA:	1953.43 SQ.FT	181.48 SQ.M



KEY SECTION

ROOF
22
21
20
19
18
17
16
15
14
13
12
11
10
09
08
07
06
05
04
03
02
01
PODIUM LEVEL
GROUND FLOOR
BASEMENT

KEY PLANS

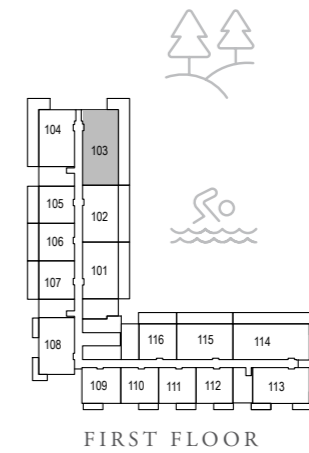

FLOOR PLAN 1. All dimensions are in imperial and metric, and measured from finish to finish excluding construction tolerances. 2. All materials, dimensions, and drawings are approximate only. 3. Information is subject to change without notice, at developer's absolute discretion. 4. Actual area may vary from the stated area. 5. Drawings not to scale. 6. All images used are for illustrative purposes only and do not represent the actual size, features, specifications, fittings, and furnishings. 7. The developer reserves the right to make revisions / alterations, at its absolute discretion, without any liability whatsoever.

PALACE

RESIDENCES DUBAI HILLS ESTATE

3 BEDROOM TYPE A.4

UNIT: 214, 314, 414, 514, 614, 714, 814, 914, 1014, 1114,
1214, 1314, 1414, 1514, 1614, 1714

SUITE AREA:	1361.2 SQ.FT	126.46 SQ.M
BALCONY AREA:	182.45 SQ.FT	16.95 SQ.M
TOTAL AREA:	1543.65 SQ.FT	143.41 SQ.M



KEY SECTION

ROOF
22
21
20
19
18
17
16
15
14
13
12
11
10
09
08
07
06
05
04
03
02
01
PODIUM LEVEL
GROUND FLOOR
BASEMENT

KEY PLANS

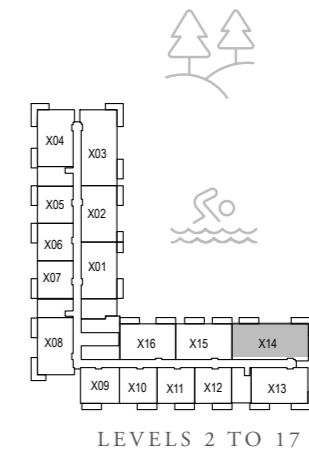

FLOOR PLAN 1. All dimensions are in imperial and metric, and measured from finish to finish excluding construction tolerances. 2. All materials, dimensions, and drawings are approximate only. 3. Information is subject to change without notice, at developer's absolute discretion. 4. Actual area may vary from the stated area. 5. Drawings not to scale. 6. All images used are for illustrative purposes only and do not represent the actual size, features, specifications, fittings, and furnishings. 7. The developer reserves the right to make revisions / alterations, at its absolute discretion, without any liability whatsoever.

PALACE

RESIDENCES DUBAI HILLS ESTATE

3 BEDROOM TYPE A.5

UNIT: 114

SUITE AREA:	1361.53 SQ.FT	126.49 SQ.M
BALCONY AREA:	597.18 SQ.FT	55.48 SQ.M
TOTAL AREA:	1958.71 SQ.FT	181.97 SQ.M



KEY SECTION

ROOF
22
21
20
19
18
17
16
15
14
13
12
11
10
09
08
07
06
05
04
03
02
01
PODIUM LEVEL
GROUND FLOOR
BASEMENT

KEY PLANS

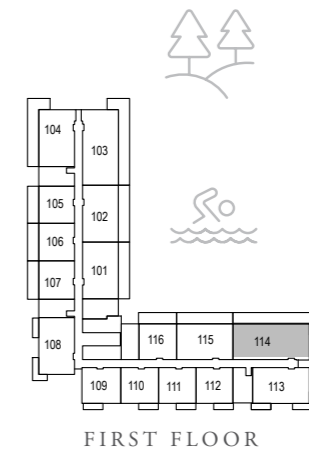

FLOOR PLAN 1. All dimensions are in imperial and metric, and measured from finish to finish excluding construction tolerances. 2. All materials, dimensions, and drawings are approximate only. 3. Information is subject to change without notice, at developer's absolute discretion. 4. Actual area may vary from the stated area. 5. Drawings not to scale. 6. All images used are for illustrative purposes only and do not represent the actual size, features, specifications, fittings, and furnishings. 7. The developer reserves the right to make revisions / alterations, at its absolute discretion, without any liability whatsoever.

PALACE

RESIDENCES DUBAI HILLS ESTATE

3 BEDROOM TYPE B.1

UNIT: 1802, 1902, 2002, 2102, 2202

SUITE AREA:	1341.08 SQ.FT	124.59 SQ.M
BALCONY AREA:	142.08 SQ.FT	13.2 SQ.M
TOTAL AREA:	1483.16 SQ.FT	137.79 SQ.M



KEY SECTION

ROOF
22
21
20
19
18
17
16
15
14
13
12
11
10
09
08
07
06
05
04
03
02
01
PODIUM LEVEL
GROUND FLOOR
BASEMENT

KEY PLANS

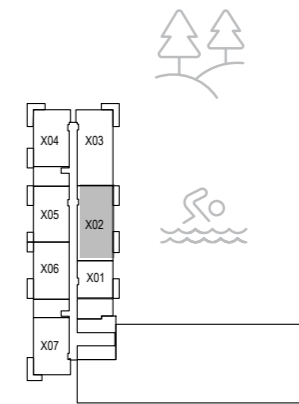

LEVELS 18 TO 22

FLOOR PLAN 1. All dimensions are in imperial and metric, and measured from finish to finish excluding construction tolerances. 2. All materials, dimensions, and drawings are approximate only. 3. Information is subject to change without notice, at developer's absolute discretion. 4. Actual area may vary from the stated area. 5. Drawings not to scale. 6. All images used are for illustrative purposes only and do not represent the actual size, features, specifications, fittings, and furnishings. 7. The developer reserves the right to make revisions / alterations, at its absolute discretion, without any liability whatsoever.



TANAMI
P R O P E R T I E S

CONTACT US

 +971 4 248 3400 |  +971 55 162 3236

Email Us

info@tanamiproperties.ae

For More Info...

www.tanamiproperties.com/Projects/Palace-Residences-at-Dubai-Hills-Estate



ADDRESS

Office 3405, Marina Plaza,
Al Marsa Street, Dubai Marina, UAE