

# PARK LANE

DUBAI HILLS ESTATE

— INTERIORS BY VIDA —

---

FLOOR PLAN - BUILDING 1B

---

EMAAR

# PARK LANE

DUBAI HILLS ESTATE

INTERIORS BY VIDA

## 1 BEDROOM

TYPE 1 | BUILDING 1B

UNITS 209, 309, 409, 509, 609, 709, 809, 909, 1009, 1109, 1209, 1309, 1409, 1509, 1609, 1709, 1809, 1909, 2009, 2109

SUITE AREA	585.02 SQFT	54.35 SQM
BALCONY AREA	71.8 SQFT	6.67 SQM
TOTAL AREA	656.81 SQFT	61.02 SQM

UNITS 107

SUITE AREA	585.56 SQFT	54.4 SQM
BALCONY AREA	71.9 SQFT	6.68 SQM
TOTAL AREA	657.46 SQFT	61.08 SQM



KEY SECTION

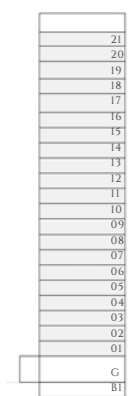

BUILDING 1B

KEY PLAN

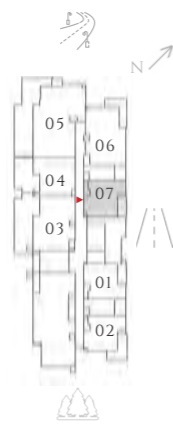

LEVEL 01

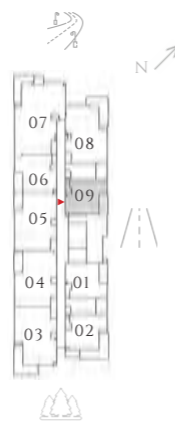

TYPICAL FLOORS (LEVEL 02 - 17)

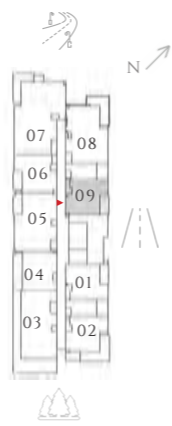

TIER 01 (LEVEL- 18)

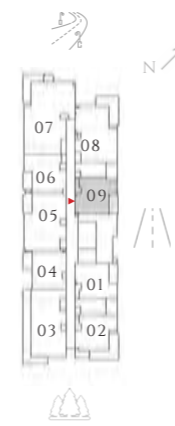

TIER 02 (LEVEL- 19)

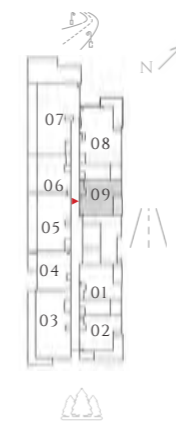

TIER 03 (LEVEL- 20)

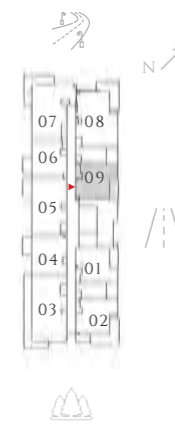

TIER 04 (LEVEL- 21)

FLOOR PLAN 1. All dimensions are in imperial and metric, and measured from finish to finish excluding construction tolerances. 2. All materials, dimensions, and drawings are approximate only. 3. Information is subject to change without notice, at developer's absolute discretion. 4. Actual area may vary from the stated area. 5. Drawings not to scale. 6. All images used are for illustrative purposes only and do not represent the actual size, features, specifications, fittings, and furnishings. 7. The developer reserves the right to make revisions / alterations, at it's absolute discretion, without any liability whatsoever.

# PARK LANE

DUBAI HILLS ESTATE

INTERIORS BY VIDA

## 1 BEDROOM

TYPE 1 MIRROR | BUILDING 1B

UNITS 101, 201, 301, 401, 501, 601, 701, 801, 901, 1001, 1101, 1201, 1301, 1401, 1501, 1601, 1701, 1801, 1901, 2001, 2101

SUITE AREA	586.96 SQFT	54.53 SQM
BALCONY AREA	71.47 SQFT	6.64 SQM
TOTAL AREA	658.43 SQFT	61.17 SQM



KEY SECTION



BUILDING 1B

KEY PLAN

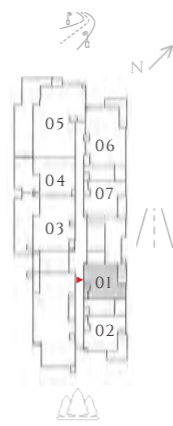

LEVEL 01

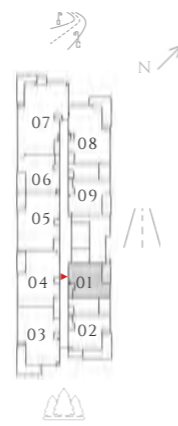

TYPICAL FLOORS (LEVEL- 17)

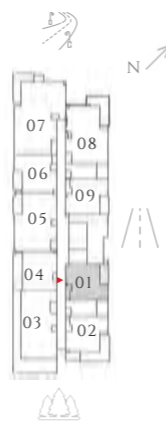

TIER 01 (LEVEL- 18)

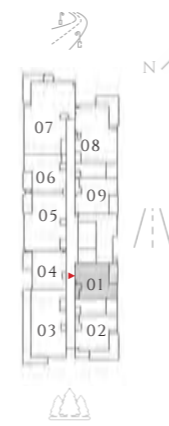

TIER 02 (LEVEL- 19)

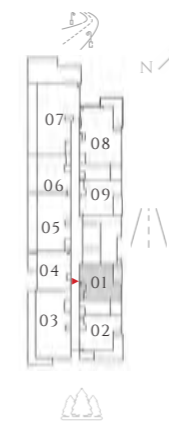

TIER 03 (LEVEL- 20)

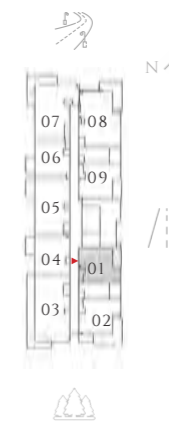

TIER 04 (LEVEL- 21)

FLOOR PLAN 1. All dimensions are in imperial and metric, and measured from finish to finish excluding construction tolerances. 2. All materials, dimensions, and drawings are approximate only. 3. Information is subject to change without notice, at developer's absolute discretion. 4. Actual area may vary from the stated area. 5. Drawings not to scale. 6. All images used are for illustrative purposes only and do not represent the actual size, features, specifications, fittings, and furnishings. 7. The developer reserves the right to make revisions / alterations, at it's absolute discretion, without any liability whatsoever.

# PARK LANE

DUBAI HILLS ESTATE

INTERIORS BY VIDA

## 1 BEDROOM

TYPE 1 MIRROR | BUILDING 1B

UNITS 1806

SUITE AREA	583.4 SQFT	54.2 SQM
BALCONY AREA	67.49 SQFT	6.27 SQM
TOTAL AREA	650.89 SQFT	60.47 SQM

UNITS 206, 306, 406, 506, 606, 706, 806, 906, 1006, 1106, 1206, 1306, 1406, 1506, 1606, 1706, 1906

SUITE AREA	583.4 SQFT	54.2 SQM
BALCONY AREA	68.14 SQFT	6.33 SQM
TOTAL AREA	651.54 SQFT	60.53 SQM



KEY SECTION



BUILDING 1B

KEY PLAN

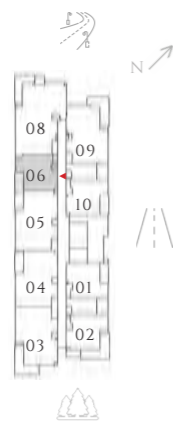

TYPICAL FLOORS (LEVEL 02 - 17)

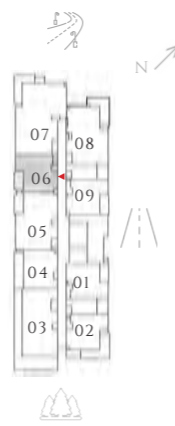

TIER 01 (LEVEL- 18)

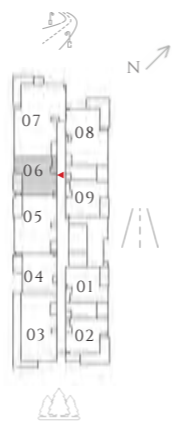

TIER 02 (LEVEL- 19)

FLOOR PLAN 1. All dimensions are in imperial and metric, and measured from finish to finish excluding construction tolerances. 2. All materials, dimensions, and drawings are approximate only. 3. Information is subject to change without notice, at developer's absolute discretion. 4. Actual area may vary from the stated area. 5. Drawings not to scale. 6. All images used are for illustrative purposes only and do not represent the actual size, features, specifications, fittings, and furnishings. 7. The developer reserves the right to make revisions / alterations, at it's absolute discretion, without any liability whatsoever.

# PARK LANE

DUBAI HILLS ESTATE

INTERIORS BY VIDA

## 1 BEDROOM

TYPE 1A | BUILDING 1B

UNITS 202, 302, 402, 502, 602, 702, 802, 902, 1002, 1102, 1202, 1302, 1402, 1502, 1602, 1802

SUITE AREA	582 SQFT	54.07 SQM
BALCONY AREA	176.53 SQFT	16.4 SQM
TOTAL AREA	758.53 SQFT	70.47 SQM

UNITS 102, 1702, 1902, 2002, 2102

SUITE AREA	582.44 SQFT	54.11 SQM
BALCONY AREA	176.64 SQFT	16.41 SQM
TOTAL AREA	759.07 SQFT	70.52 SQM



KEY SECTION



BUILDING 1B

KEY PLAN

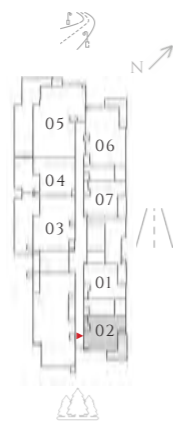

LEVEL 01

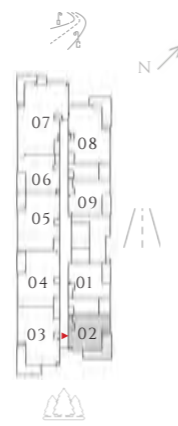

TYPICAL FLOORS (LEVEL 02 - 17)

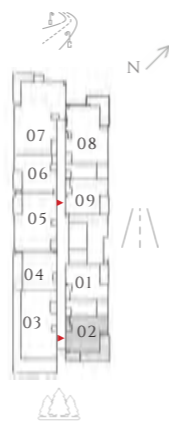

TIER 01 (LEVEL- 18)

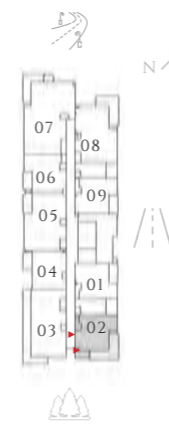

TIER 02 (LEVEL- 19)

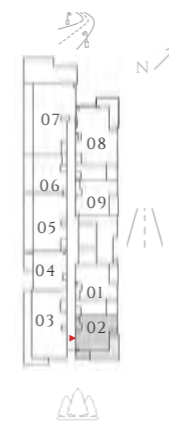

TIER 03 (LEVEL- 20)

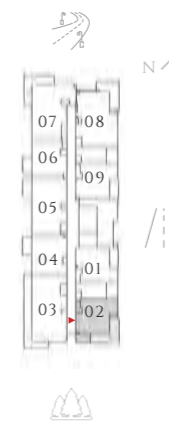

TIER 04 (LEVEL- 21)

FLOOR PLAN 1. All dimensions are in imperial and metric, and measured from finish to finish excluding construction tolerances. 2. All materials, dimensions, and drawings are approximate only. 3. Information is subject to change without notice, at developer's absolute discretion. 4. Actual area may vary from the stated area. 5. Drawings not to scale. 6. All images used are for illustrative purposes only and do not represent the actual size, features, specifications, fittings, and furnishings. 7. The developer reserves the right to make revisions / alterations, at it's absolute discretion, without any liability whatsoever.

# PARK LANE

DUBAI HILLS ESTATE

INTERIORS BY VIDA

## 1 BEDROOM

TYPE 1.1 MIRROR | BUILDING 1B

UNITS 104

SUITE AREA	583.3 SQFT	54.19 SQM
BALCONY AREA	382.01 SQFT	35.49 SQM
TOTAL AREA	965.31 SQFT	89.68 SQM



KEY SECTION

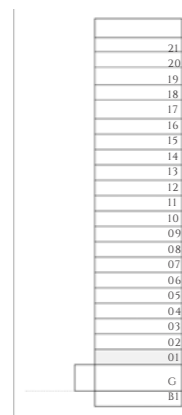

BUILDING 1B

KEY PLAN

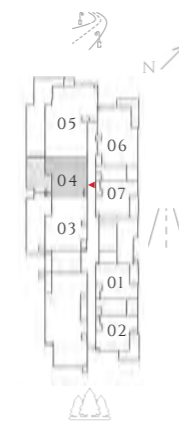

LEVEL 01

FLOOR PLAN 1. All dimensions are in imperial and metric, and measured from finish to finish excluding construction tolerances. 2. All materials, dimensions, and drawings are approximate only. 3. Information is subject to change without notice, at developer's absolute discretion. 4. Actual area may vary from the stated area. 5. Drawings not to scale. 6. All images used are for illustrative purposes only and do not represent the actual size, features, specifications, fittings, and furnishings. 7. The developer reserves the right to make revisions / alterations, at it's absolute discretion, without any liability whatsoever.

# PARK LANE

DUBAI HILLS ESTATE

INTERIORS BY VIDA

## 1 BEDROOM

TYPE 02 | BUILDING 1B

UNITS 1804

SUITE AREA	592.66 SQFT	55.06 SQM
BALCONY AREA	137.46 SQFT	12.77 SQM
TOTAL AREA	730.12 SQFT	67.83 SQM



KEY SECTION



BUILDING 1B

KEY PLAN

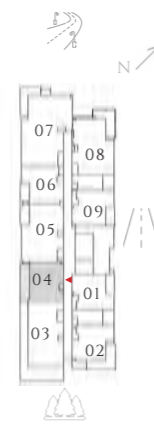

LEVEL 18

FLOOR PLAN 1. All dimensions are in imperial and metric, and measured from finish to finish excluding construction tolerances. 2. All materials, dimensions, and drawings are approximate only. 3. Information is subject to change without notice, at developer's absolute discretion. 4. Actual area may vary from the stated area. 5. Drawings not to scale. 6. All images used are for illustrative purposes only and do not represent the actual size, features, specifications, fittings, and furnishings. 7. The developer reserves the right to make revisions / alterations, at it's absolute discretion, without any liability whatsoever.

# PARK LANE

DUBAI HILLS ESTATE

INTERIORS BY VIDA

## 1 BEDROOM

TYPE 2.1 | BUILDING 1B

UNITS 1904

SUITE AREA	592.55 SQFT	55.05 SQM
BALCONY AREA	65.12 SQFT	6.05 SQM
TOTAL AREA	657.67 SQFT	61.1 SQM

UNITS 2004, 2104

SUITE AREA	593.09 SQFT	55.1 SQM
BALCONY AREA	56.83 SQFT	5.28 SQM
TOTAL AREA	649.92 SQFT	60.38 SQM



KEY SECTION



BUILDING 1B

KEY PLAN

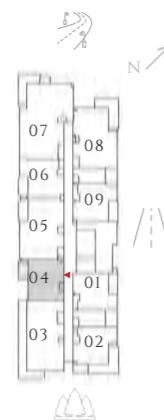

TIER 02 (LEVEL- 19)

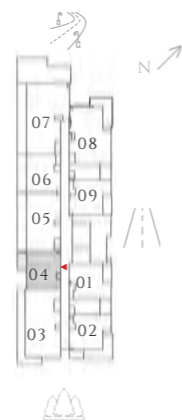

TIER 03 (LEVEL- 20)

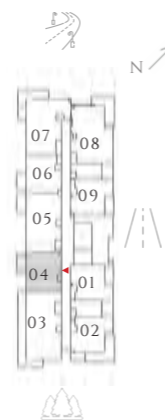

TIER 04 (LEVEL- 21)

FLOOR PLAN 1. All dimensions are in imperial and metric, and measured from finish to finish excluding construction tolerances. 2. All materials, dimensions, and drawings are approximate only. 3. Information is subject to change without notice, at developer's absolute discretion. 4. Actual area may vary from the stated area. 5. Drawings not to scale. 6. All images used are for illustrative purposes only and do not represent the actual size, features, specifications, fittings, and furnishings. 7. The developer reserves the right to make revisions / alterations, at it's absolute discretion, without any liability whatsoever.



# PARK LANE

DUBAI HILLS ESTATE

INTERIORS BY VIDA

## 1 BEDROOM

TYPE 03 | BUILDING 1A

UNITS 2006

SUITE AREA	550.14 SQFT	51.11 SQM
BALCONY AREA	135.95 SQFT	12.63 SQM
TOTAL AREA	686.09 SQFT	63.74 SQM



KEY SECTION



BUILDING 1B

KEY PLAN

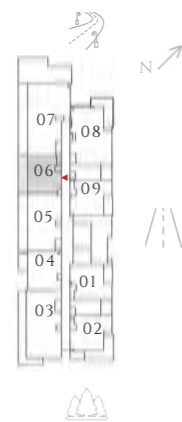

TIER 03 (LEVEL- 20)

FLOOR PLAN 1. All dimensions are in imperial and metric, and measured from finish to finish excluding construction tolerances. 2. All materials, dimensions, and drawings are approximate only. 3. Information is subject to change without notice, at developer's absolute discretion. 4. Actual area may vary from the stated area. 5. Drawings not to scale. 6. All images used are for illustrative purposes only and do not represent the actual size, features, specifications, fittings, and furnishings. 7. The developer reserves the right to make revisions / alterations, at it's absolute discretion, without any liability whatsoever.

# PARK LANE

DUBAI HILLS ESTATE

INTERIORS BY VIDA

## 1 BEDROOM

TYPE 3.1 | BUILDING 1B

UNITS 2106

SUITE AREA	550.25 SQFT	51.12 SQM
BALCONY AREA	56.73 SQFT	5.27 SQM
TOTAL AREA	606.98 SQFT	56.39 SQM



KEY SECTION



BUILDING 1B

KEY PLAN

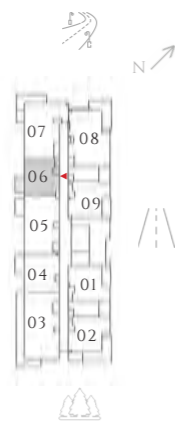

TIER 04 (LEVEL- 21)

FLOOR PLAN 1. All dimensions are in imperial and metric, and measured from finish to finish excluding construction tolerances. 2. All materials, dimensions, and drawings are approximate only. 3. Information is subject to change without notice, at developer's absolute discretion. 4. Actual area may vary from the stated area. 5. Drawings not to scale. 6. All images used are for illustrative purposes only and do not represent the actual size, features, specifications, fittings, and furnishings. 7. The developer reserves the right to make revisions / alterations, at it's absolute discretion, without any liability whatsoever.

# PARK LANE

DUBAI HILLS ESTATE

INTERIORS BY VIDA

## 2 BEDROOM

TYPE 1 | BUILDING 1B

UNITS 106, 208, 308, 408, 508, 608, 708, 808, 908, 1008, 1108, 1208, 1308, 1408, 1508, 1608, 1708, 1808, 1908

SUITE AREA	960.79 SQFT	89.26 SQM
BALCONY AREA	160.27 SQFT	14.89 SQM
TOTAL AREA	1121.06 SQFT	104.15 SQM

UNITS 203, 303, 403, 503, 603, 703, 803, 903, 1003, 1103, 1203, 1303, 1403, 1503, 1603, 1703

SUITE AREA	958.74 SQFT	89.07 SQM
BALCONY AREA	171.15 SQFT	15.9 SQM
TOTAL AREA	1129.89 SQFT	104.97 SQM



KEY SECTION



BUILDING 1B

KEY PLAN

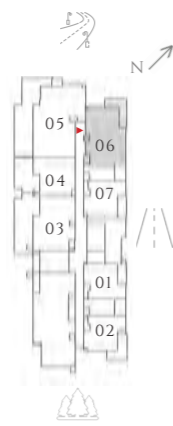

LEVEL 01

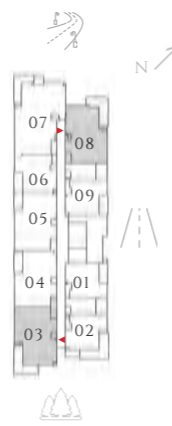

TYPICAL FLOORS (LEVEL 02 - 17)

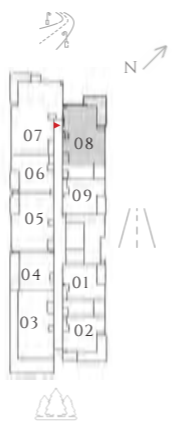

TIER 01 (LEVEL- 18)

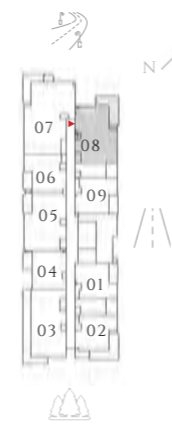

TIER 02 (LEVEL- 19)

FLOOR PLAN 1. All dimensions are in imperial and metric, and measured from finish to finish excluding construction tolerances. 2. All materials, dimensions, and drawings are approximate only. 3. Information is subject to change without notice, at developer's absolute discretion. 4. Actual area may vary from the stated area. 5. Drawings not to scale. 6. All images used are for illustrative purposes only and do not represent the actual size, features, specifications, fittings, and furnishings. 7. The developer reserves the right to make revisions / alterations, at it's absolute discretion, without any liability whatsoever.

# PARK LANE

DUBAI HILLS ESTATE

INTERIORS BY VIDA

## 2 BEDROOM

TYPE 1 | BUILDING 1B

UNITS 2008

SUITE AREA	961.76 SQFT	89.35 SQM
BALCONY AREA	161.35 SQFT	14.99 SQM
TOTAL AREA	1123.11 SQFT	104.34 SQM

UNITS 2108

SUITE AREA	961.76 SQFT	89.35 SQM
BALCONY AREA	160.49 SQFT	14.91 SQM
TOTAL AREA	1122.25 SQFT	104.26 SQM



KEY SECTION



BUILDING 1B

KEY PLAN

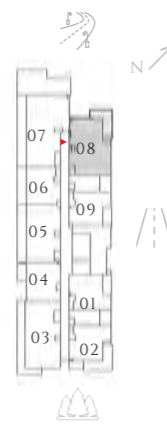

TIER 03 LEVEL 20

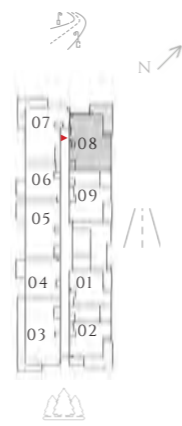

TIER 04 (LEVEL - 21)

FLOOR PLAN 1. All dimensions are in imperial and metric, and measured from finish to finish excluding construction tolerances. 2. All materials, dimensions, and drawings are approximate only. 3. Information is subject to change without notice, at developer's absolute discretion. 4. Actual area may vary from the stated area. 5. Drawings not to scale. 6. All images used are for illustrative purposes only and do not represent the actual size, features, specifications, fittings, and furnishings. 7. The developer reserves the right to make revisions / alterations, at it's absolute discretion, without any liability whatsoever.

# PARK LANE

DUBAI HILLS ESTATE

INTERIORS BY VIDA

## 2 BEDROOM

TYPE 1 A | BUILDING 1B

UNITS 204, 304, 404, 504, 604, 704, 804, 904, 1004, 1104, 1204, 1304, 1404, 1504, 1604, 1704

SUITE AREA	963.15 SQFT	89.48 SQM
BALCONY AREA	73.41 SQFT	6.82 SQM
TOTAL AREA	1036.56 SQFT	96.3 SQFT

UNITS 205, 305, 405, 505, 605, 705, 805, 905, 1005, 1105, 1205, 1305, 1405, 1505, 1605, 1705, 1905

SUITE AREA	962.94 SQFT	89.46 SQM
BALCONY AREA	77.5 SQFT	7.2 SQM
TOTAL AREA	1040.44 SQFT	96.66 SQM



KEY SECTION



BUILDING 1B

KEY PLAN

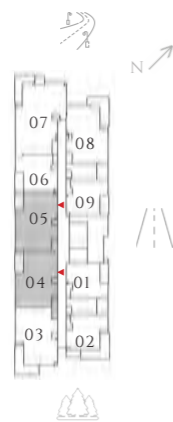

TYPICAL FLOOR (LEVEL 02-17)

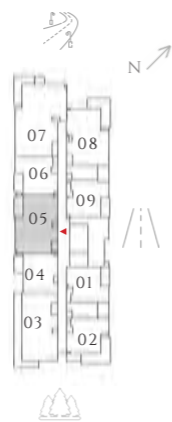

TIER 02 (LEVEL- 19)

FLOOR PLAN 1. All dimensions are in imperial and metric, and measured from finish to finish excluding construction tolerances. 2. All materials, dimensions, and drawings are approximate only. 3. Information is subject to change without notice, at developer's absolute discretion. 4. Actual area may vary from the stated area. 5. Drawings not to scale. 6. All images used are for illustrative purposes only and do not represent the actual size, features, specifications, fittings, and furnishings. 7. The developer reserves the right to make revisions / alterations, at it's absolute discretion, without any liability whatsoever.

# PARK LANE

DUBAI HILLS ESTATE

INTERIORS BY VIDA

## 2 BEDROOM

TYPE 1 A | BUILDING 1B

UNITS 1805

SUITE AREA	963.59 SQFT	89.52 SQM
BALCONY AREA	78.15 SQFT	7.26 SQM
TOTAL AREA	1041.73 SQFT	96.78 SQM



KEY SECTION



BUILDING 1B

KEY PLAN

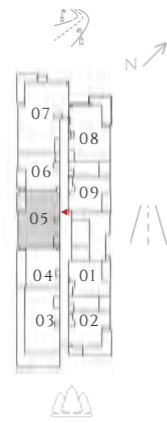

TIER 01 (LEVEL- 18)

FLOOR PLAN 1. All dimensions are in imperial and metric, and measured from finish to finish excluding construction tolerances. 2. All materials, dimensions, and drawings are approximate only. 3. Information is subject to change without notice, at developer's absolute discretion. 4. Actual area may vary from the stated area. 5. Drawings not to scale. 6. All images used are for illustrative purposes only and do not represent the actual size, features, specifications, fittings, and furnishings. 7. The developer reserves the right to make revisions / alterations, at it's absolute discretion, without any liability whatsoever.

# PARK LANE

DUBAI HILLS ESTATE

INTERIORS BY VIDA

## 2 BEDROOM

TYPE 1A.1 | BUILDING 1B

UNITS 103

SUITE AREA	962.94 SQFT	89.46 SQM
BALCONY AREA	603.53 SQFT	56.07 SQM
TOTAL AREA	1566.47 SQFT	145.53 SQM



KEY SECTION



BUILDING 1B

KEY PLAN

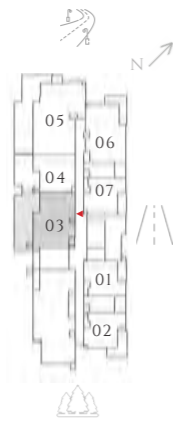

LEVEL 01

FLOOR PLAN 1. All dimensions are in imperial and metric, and measured from finish to finish excluding construction tolerances. 2. All materials, dimensions, and drawings are approximate only. 3. Information is subject to change without notice, at developer's absolute discretion. 4. Actual area may vary from the stated area. 5. Drawings not to scale. 6. All images used are for illustrative purposes only and do not represent the actual size, features, specifications, fittings, and furnishings. 7. The developer reserves the right to make revisions / alterations, at it's absolute discretion, without any liability whatsoever.

# PARK LANE

DUBAI HILLS ESTATE

INTERIORS BY VIDA

## 2 BEDROOM

TYPE 2 | BUILDING 1B

UNIT 1803

SUITE AREA	977.04 SQFT	90.77 SQM
BALCONY AREA	527.65 SQFT	49.02 SQM
TOTAL AREA	1504.69 SQFT	139.79 SQM



KEY SECTION



BUILDING 1B

KEY PLAN

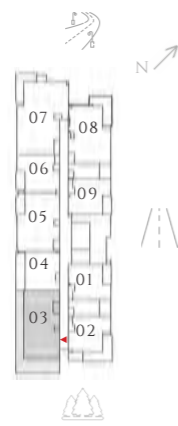

LEVEL 18

FLOOR PLAN 1. All dimensions are in imperial and metric, and measured from finish to finish excluding construction tolerances. 2. All materials, dimensions, and drawings are approximate only. 3. Information is subject to change without notice, at developer's absolute discretion. 4. Actual area may vary from the stated area. 5. Drawings not to scale. 6. All images used are for illustrative purposes only and do not represent the actual size, features, specifications, fittings, and furnishings. 7. The developer reserves the right to make revisions / alterations, at it's absolute discretion, without any liability whatsoever.



# PARK LANE

DUBAI HILLS ESTATE

INTERIORS BY VIDA

## 2 BEDROOM

TYPE 2.1 | BUILDING 1

UNITS 1903, 2003, 2103

SUITE AREA	977.47 SQFT	90.81 SQM
BALCONY AREA	330.13 SQFT	30.67 SQM
TOTAL AREA	1307.6 SQFT	121.48 SQM



KEY SECTION



BUILDING 1B

KEY PLAN

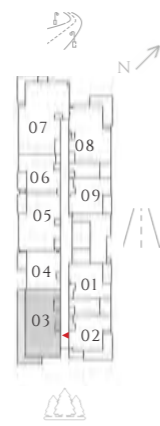

TIER 02 (LEVEL-19)

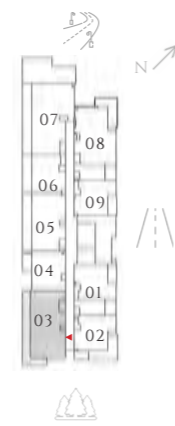

TIER03 (LEVEL-20)

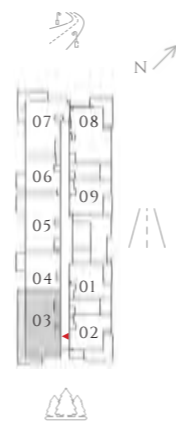

TIER04 (LEVEL-21)

FLOOR PLAN 1. All dimensions are in imperial and metric, and measured from finish to finish excluding construction tolerances. 2. All materials, dimensions, and drawings are approximate only. 3. Information is subject to change without notice, at developer's absolute discretion. 4. Actual area may vary from the stated area. 5. Drawings not to scale. 6. All images used are for illustrative purposes only and do not represent the actual size, features, specifications, fittings, and furnishings. 7. The developer reserves the right to make revisions / alterations, at it's absolute discretion, without any liability whatsoever.

# PARK LANE

DUBAI HILLS ESTATE

INTERIORS BY VIDA

## 2 BEDROOM

TYPE 3 | BUILDING 1B

UNITS 2005

SUITE AREA	866.06 SQFT	80.46 SQM
BALCONY AREA	223.46 SQFT	20.76 SQM
TOTAL AREA	1089.52 SQFT	101.22 SQM



KEY SECTION



BUILDING 1B

KEY PLAN

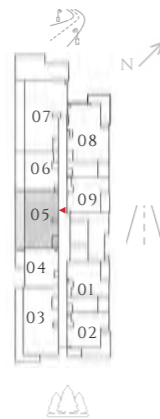

TIER 03 (LEVEL- 20)

FLOOR PLAN 1. All dimensions are in imperial and metric, and measured from finish to finish excluding construction tolerances. 2. All materials, dimensions, and drawings are approximate only. 3. Information is subject to change without notice, at developer's absolute discretion. 4. Actual area may vary from the stated area. 5. Drawings not to scale. 6. All images used are for illustrative purposes only and do not represent the actual size, features, specifications, fittings, and furnishings. 7. The developer reserves the right to make revisions / alterations, at it's absolute discretion, without any liability whatsoever.

# PARK LANE

DUBAI HILLS ESTATE

INTERIORS BY VIDA

## 2 BEDROOM

TYPE 3.1 | BUILDING 1B

UNIT 2105

SUITE AREA	866.06 SQFT	80.46 SQM
BALCONY AREA	56.83 SQFT	5.28 SQM
TOTAL AREA	922.9 SQFT	85.74 SQM



KEY SECTION



BUILDING 1B

KEY PLAN

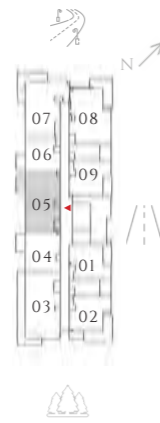

TIER 04 (LEVEL- 21)

FLOOR PLAN 1. All dimensions are in imperial and metric, and measured from finish to finish excluding construction tolerances. 2. All materials, dimensions, and drawings are approximate only. 3. Information is subject to change without notice, at developer's absolute discretion. 4. Actual area may vary from the stated area. 5. Drawings not to scale. 6. All images used are for illustrative purposes only and do not represent the actual size, features, specifications, fittings, and furnishings. 7. The developer reserves the right to make revisions / alterations, at it's absolute discretion, without any liability whatsoever.

# PARK LANE

DUBAI HILLS ESTATE

INTERIORS BY VIDA

## 2 BEDROOM

TYPE 4 | BUILDING 1B

UNIT 2007

SUITE AREA	923.54 SQFT	85.8 SQM
BALCONY AREA	794.27 SQFT	73.79 SQM
TOTAL AREA	1717.81 SQFT	159.59 SQM



KEY SECTION



BUILDING 1B

KEY PLAN

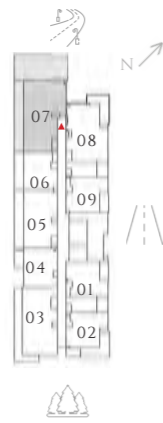

TIER 03 (LEVEL- 20)

FLOOR PLAN 1. All dimensions are in imperial and metric, and measured from finish to finish excluding construction tolerances. 2. All materials, dimensions, and drawings are approximate only. 3. Information is subject to change without notice, at developer's absolute discretion. 4. Actual area may vary from the stated area. 5. Drawings not to scale. 6. All images used are for illustrative purposes only and do not represent the actual size, features, specifications, fittings, and furnishings. 7. The developer reserves the right to make revisions / alterations, at it's absolute discretion, without any liability whatsoever.

# PARK LANE

DUBAI HILLS ESTATE

INTERIORS BY VIDA

## 2 BEDROOM

TYPE 4.1 | BUILDING 1B

UNIT 2107

SUITE AREA	922.79 SQFT	85.73 SQM
BALCONY AREA	133.9 SQFT	12.44 SQM
TOTAL AREA	1056.69 SQFT	98.17 SQM



KEY SECTION



BUILDING 1B

KEY PLAN

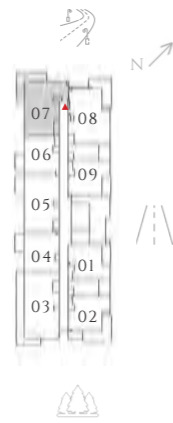

TIER 04 (LEVEL- 21)

FLOOR PLAN 1. All dimensions are in imperial and metric, and measured from finish to finish excluding construction tolerances. 2. All materials, dimensions, and drawings are approximate only. 3. Information is subject to change without notice, at developer's absolute discretion. 4. Actual area may vary from the stated area. 5. Drawings not to scale. 6. All images used are for illustrative purposes only and do not represent the actual size, features, specifications, fittings, and furnishings. 7. The developer reserves the right to make revisions / alterations, at it's absolute discretion, without any liability whatsoever.

# PARK LANE

DUBAI HILLS ESTATE

INTERIORS BY VIDA

## 3 BEDROOM

TYPE 1 | BUILDING 1B

UNIT 1707

SUITE AREA	1369.38 SQFT	127.22 SQM
BALCONY AREA	154.68 SQFT	14.37 SQM
TOTAL AREA	1524.06 SQFT	141.59 SQM

UNITS 207, 307, 407, 507, 607, 707, 807, 907, 1007, 1107, 1207, 1307, 1407, 1507, 1607, 1807, 1907

SUITE AREA	1368.74 SQFT	127.16 SQM
BALCONY AREA	154.68 SQFT	14.37 SQM
TOTAL AREA	1523.42 SQFT	141.53 SQM



KEY SECTION



BUILDING 1B

KEY PLAN

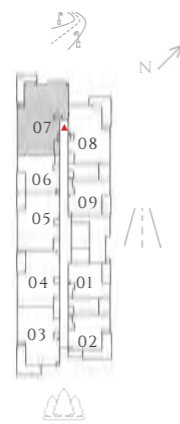

TYPICAL FLOORS (LEVEL02 - 17)

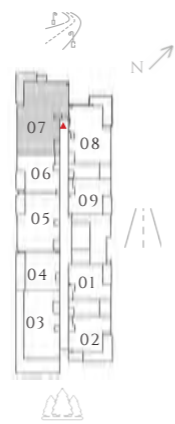

TIER 01 (LEVEL- 18)

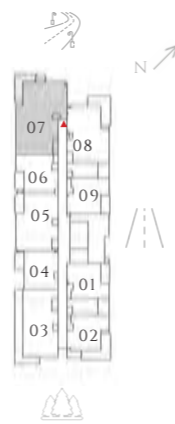

TIER 02 (LEVEL- 19)

FLOOR PLAN 1. All dimensions are in imperial and metric, and measured from finish to finish excluding construction tolerances. 2. All materials, dimensions, and drawings are approximate only. 3. Information is subject to change without notice, at developer's absolute discretion. 4. Actual area may vary from the stated area. 5. Drawings not to scale. 6. All images used are for illustrative purposes only and do not represent the actual size, features, specifications, fittings, and furnishings. 7. The developer reserves the right to make revisions / alterations, at it's absolute discretion, without any liability whatsoever.

# PARK LANE

DUBAI HILLS ESTATE

INTERIORS BY VIDA

## 3 BEDROOM

TYPE 1.1 | BUILDING 1B

UNIT 105

SUITE AREA	1367.55 SQFT	127.05 SQM
BALCONY AREA	749.92 SQFT	69.67 SQM
TOTAL AREA	2117.48 SQFT	196.72 SQFT



KEY SECTION



BUILDING 1B

KEY PLAN

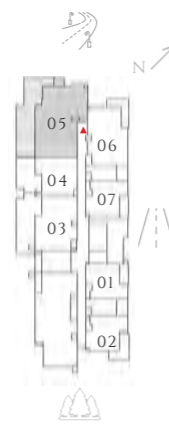

LEVEL 01

FLOOR PLAN 1. All dimensions are in imperial and metric, and measured from finish to finish excluding construction tolerances. 2. All materials, dimensions, and drawings are approximate only. 3. Information is subject to change without notice, at developer's absolute discretion. 4. Actual area may vary from the stated area. 5. Drawings not to scale. 6. All images used are for illustrative purposes only and do not represent the actual size, features, specifications, fittings, and furnishings. 7. The developer reserves the right to make revisions / alterations, at it's absolute discretion, without any liability whatsoever.